

Typ ZLND 32 - 125 ... 300 - 500

TECHNICAL DATA

Flow:	max. 1800 m ³ /h
Head:	max. 140 m
Speed:	max. 3600 rpm
Material:	cast iron (0B,0C,0E) and stainless steel (4B)
Temperature:	max. 170 °C depending on the shaft sealing and material execution.
Casing Pressure:	material design 4B PN 16 0B, 0C, 0E PN 16 / 10 ¹⁾ / 14 ²⁾
Shaft sealing:	mechanical seal or stuffing box
Flange connections:	material design 4B DIN 2501 PN 16 0B, 0C, 0E DIN 2501 PN 16 / 10 ³⁾
Direction of rotation:	clockwise when looking at the pump from the drive end.

APPLICATION

Volute casing pumps of the ZLN range (meeting DIN 24255 / EN 733 and ISO 99089) are used when clear or turbid liquids free from solid particles are to be pumped. Application areas for pumps in this range include:

Automobile, mechanical and general engineering industries
 Food and beverage industry
 Pharmaceutical industry
 Paint industry
 Plastic and rubber industry
 Iron and non-ferrous metal industry
 Paper and pulp industry
 Textile industry
 Building and construction industry
 Heating and air conditioning
 Drainage
 Water supply
 Irrigation

A range of materials is available to meet the specific needs of Customers. For applications not covered by this pump range we offer the ISOchem range.

DESIGN

Horizontal, single-stage volute casing pumps with connections and main dimensions to DIN 24255 / EN 733, plus 19 additional sizes. The design of the pump allows the complete drive unit to be withdrawn from the casing without disturbing the attached pipe work. If a spacer type coupling is used, it is also unnecessary to disconnect the motor.

The range covers 50 sizes with only 5 different bearing brackets.

CONSTRUCTION

Casing pressure:

Material 4B:	max. 16 bar from - 40 °C to +120 °C max. 14 bar from +120°C to +170 °C
Material 0B, 0C, 0E:	max. 16/10 ¹⁾ /14 ²⁾ bar from - 20 °C to +120 °C max. 14/9 ¹⁾ /8 ²⁾ bar from +120 °C to +170 °C

Max. casing pressure=inlet pressure + delivery head at zero flow

Please note:

The relevant technical regulations and safety rules must be observed.

Flanges location:

Axial suction flange, discharge flange radially upwards.



Flanges:

Material design 4B: complies with DIN 2543 PN 16
 Material design 0B, 0C, 0E: DIN 2533 PN 16 / 2532 PN 10³⁾
 Flanges drilled according to ANSI 150 can be supplied.

Bearings:

Bearing brackets 25, 35 and 45: Two ball bearings, lifetime greased (2Z), design code B, or oil lubrication, design code C.
 Bearing brackets 55 and 65: One double row angular contact bearing on pump side, plus one ball bearing on drive side, grease lubricated S or oil lubricated T.
 Oil lubrication configurations with CLO (Constant Level Oiler) can be supplied.

Shaft sealing:

Shaft sealing either by stuffing box or mechanical seal.	
Code 041:	Self-sealed, uncooled packing rings
Code 052:	Uncooled packing rings, external sealing liquid
Code AF3:	Balanced mechanical seal, seal face materials SiC/Carbon, elastomer EPDM
Code BJ3:	Unbalanced bellows mechanical seal, seal face materials SiC/Carbon, elastomer EPDM
Code C23:	Unbalanced bellows mechanical seal, seal face materials SiC/Carbon, elastomer EPDM
Code AFS:	Balanced mechanical seal, seal face materials SiC/SiC, elastomer FPM (Viton)
Code BJS:	Unbalanced bellows mechanical seal, seal face materials SiC/SiC, elastomer FPM (Viton)
Code C2S:	Unbalanced bellows mechanical seal, seal face materials SiC/SiC, elastomer FPM (Viton)
Code AFK:	Balanced mechanical seal, seal face materials SiC/Carbon, elastomer FPM (Viton) double PTFE (Teflon) wrapped
Code BJJ:	Unbalanced bellows mechanical seal, seal face materials SiC/Carbon, elastomer FPM (Viton)
Code C2J:	Unbalanced bellows mechanical seal, seal face materials SiC/Carbon, elastomer FPM (Viton)

Codes AX3, AXS, AXK: are equivalent to AF3, AFS, AFK plus quench
 Codes AY3, AYS, AYK: are equivalent to AF3, AFS, AFK plus heating
 Codes A93, A9S, A9K: are equivalent to AF3, AFS, AFK plus external flushing

As an option, Code 051 (as 052, but with inlet and outlet) and other sealing execution can be supplied on request.

¹⁾ size from 80-400 to 300-500 except 150-500

²⁾ size from 150-500

³⁾ size from 150-200, 150-250 and 200-250

Material design:

Item.	Component	Material				Construction					
		EN denomination	DIN denomination	ISO EN denomination	US Material		0B	0C	0E	4B	
					ASTM Standard	AISI					
10.20	Volute casing	EN-JL 1040	GG-25	EN-GJL 250	A 278 Cl. 30		x	x	x		
		1.4408	GX6CrNiMo18 10	GX5CrNiMo19-11-2	A 351 CF8M	316				x	
16.10	Casing cover	EN-JL 1040	GG-25	EN-GJL 250	A 278 Cl. 30		x	x	x		
		1.4408	GX6CrNiMo18 10	GX5CrNiMo19-11-2	A 351 CF8M	316				x	
21.00	Shaft	1.0503	C 45	C 45	A 576 Gr1045	1045	x ¹⁾				
		1.4021	X 20 Cr13	X 20 Cr13	A 276 Type 420	420	x	x	x		
		1.4401	X5CrNiMo17 12 2	X5CrNiMo17 12 2	A 167 Gr316	316				x	
23.00	Impeller	EN-JL 1040	GG-25	EN-GJL 250	A 278 Cl. 30		x				
		2.1050	G-CuSn10		B 427 C91600			x			
		1.4408	GX6CrNiMo18 10	GX5CrNiMo19-11-2	A 351 CF8M	316			x	x	
33.00	Bearing bracket	EN-JL 1040	GG-25	EN-GJL 250	A 278 Cl. 30		x	x	x	x	
52.30	Shaft sleeve Mechanical seal	1.4021	X 20 Cr13	X 20 Cr13	A 276 Type 420	420	x	x	x		
52.40	Shaft sleeve Stuffing box	1.4021	X 20 Cr13	X 20 Cr13	A 276 Type 420	420	x	x	x		
		1.4401	X5CrNiMo17 12 2	X5CrNiMo17 12 2	A 167 Gr316	316				x	
46.10	Shaft seal Stuffing box	Soft packing						x	x	x	x
43.30	Mechanical seal	SiC/carbon, elastomer EPDM or FPM (Viton)						x	x	x	x

¹⁾ only in bearing brackets 55 and 65

Casing gasket:

The casing is sealed by means of a confined flat gasket of EWP 210 material. Code of this design: 2

The casing is sealed by means of a confined flat gasket of PTFE. Code of this design: 4

Motor Power:

Using commercial electric motors, type of construction IM B3.

To determine the drive power, we recommend the following safety margin:

Up to 4 kW: 25%

4 to 7,5 kW: 20%

above 7,5 kW: 15%

The following speeds must not be exceeded:

Size	max. speed rpm	Size	max. speed rpm	Size	max. speed rpm	Size	max. speed rpm
32125 50200	3600	32250	3000	40315 ³⁾ 125315	1800	150500 300400	1500
32160 65125		40250		50315 ³⁾ 125400		200315 300500	
32200 65160		50250		65315 150200		200400	
40125 65200 ¹⁾		65250		80315 150250 ⁴⁾		200500	
40160 80160 ¹⁾		80250		80400 150315		250300	
40200 80200		100250 ²⁾		100315 150400		250315	
50125 100160		125200 ²⁾		100400 200250		250400	
50160 100200				125250		250500	

¹⁾ In material design 4B max. speed 3000 rpm

²⁾ In material design 4B max. speed 1800 rpm

³⁾ In material design 0E and 4B max. speed 3000 rpm

⁴⁾ In material design 4B max. speed 1500 rpm

The max. speeds are derived from the permissible shaft loads and the permissible peripheral speeds of the impellers.

Bearing bracket / pump size:

Bracket 25	32125 32160 32200 32250 40125 40160 40200 40250 50125 50160 50200 50250 65125 65160 65200 80160
Bracket 35	40315 50315 65250 65315 80200 80250 80315 100160 100200 100250 100315 125200 125250 150200 150250
Bracket 45	80400 100400 125315 125400 150315 150400 200250
Bracket 55	150500 200315 200400 200500 250300 250315
Bracket 65	250400 250500 300400 300500

General comments:

For horizontal volute pumps in CLOSE COUPLED construction with STANDARD motor for nominal performances and flange connections as per EN 733 refer to our series ZLK (supplied also with magnetic drive).

For INLINE pumps with the same drive unit, consisting of bearing bracket with bearing, stub shaft and mechanical seal, casing cover, impeller and impeller nut, refer to our series ZLI (supplied also with magnetic drive).

For equipping hot media systems a complete programme is available for a flow range between 1-1000 m³/h consisting of the range:

- ZTN** volute pumps to EN 733 design with base plate, t_{max} 350 °C, PN 16. Heat transfer oil.
- ZTK** volute pumps to EN 733 close coupled design, t_{max} 350 °C, PN 16. Heat transfer oil
- ZTI** volute pumps to EN 733 as INLINE construction, t_{max} 350 °C, PN 16. Heat transfer oil.
- ZEN** volute pumps to EN 22858, t_{max} 230 °C, PN 40. Hot water design.
- ZDN** volute pumps to EN 22858, t_{max} 185 °C, PN 25. Hot water design.
- ZHN** volute pumps to EN 733, t_{max} 180 °C, PN 16. Hot water design.
- ZLI** volute pumps to EN 733 as INLINE construction, t_{max} 150 °C, PN 25. Hot water design.

Technical documentation about these programmes will be readily supplied on request.

SECTIONAL DRAWING AND NOMENCLATURE

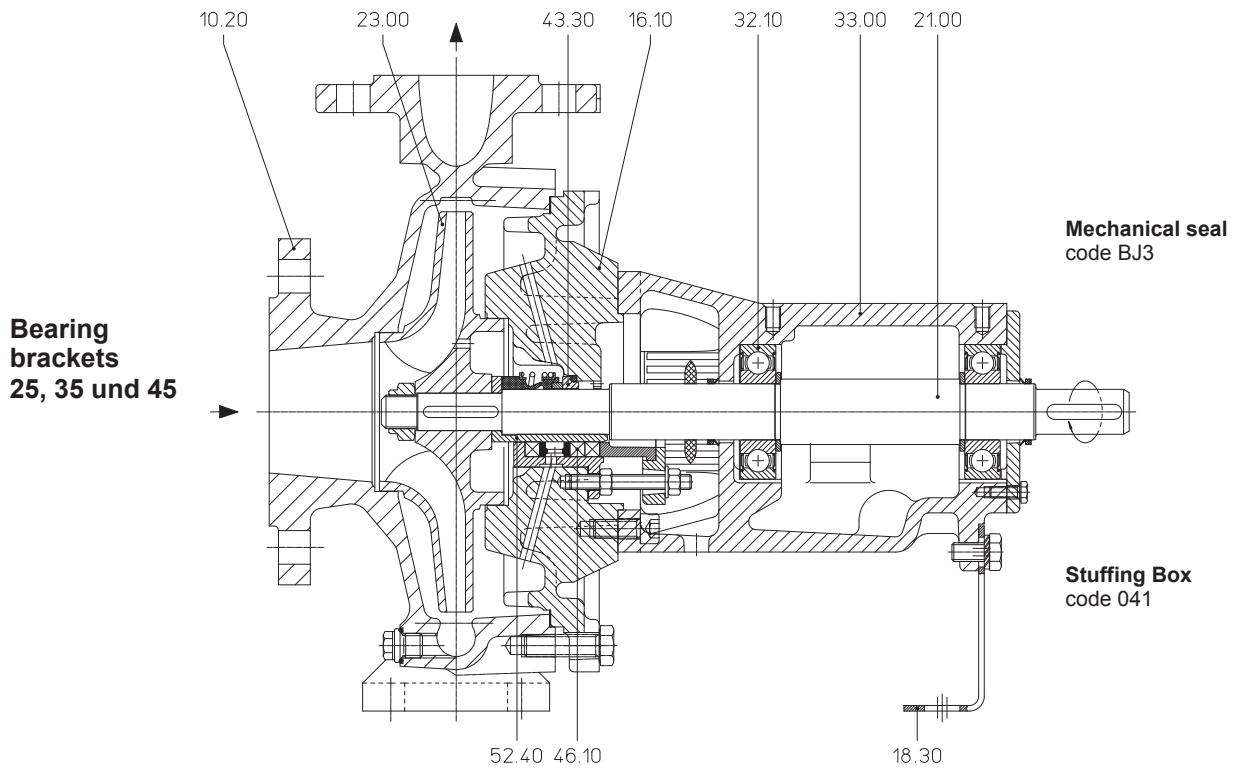

10.20	volute casing	23.00	impeller	43.30	mechanical seal
16.10	volute cover	32.10	ball bearing	46.10	stuffing box
18.30	support foot	33.00	bearing bracket	52.40	shaft sleeve (stuffing box)
21.00	shaft				

Shaft seals

Shaft seal
Code BJ3/BJ5/BJJ

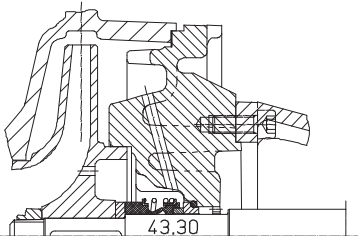

Shaft seal
Code AF3/AF5/AFK

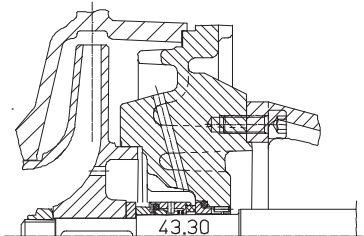

Shaft seal
Code C23/C25/C2J

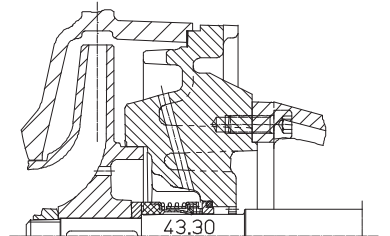

Mechanical seal with quench cover
Double lip seal ring
Code X3/AXS/AXK

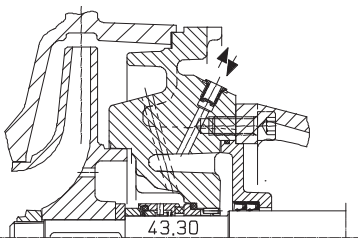

Mechanical seal with heating cover
Code AY3/AYS/AYK

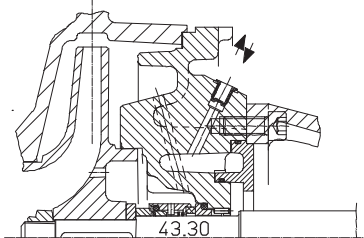

Mechanical seal with external flushing
Code A93/A95/A9K

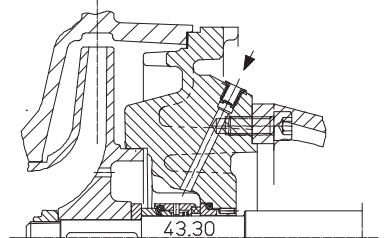

Shaft seal
Code 041

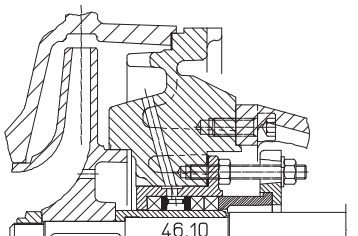

Shaft seal
Code 052

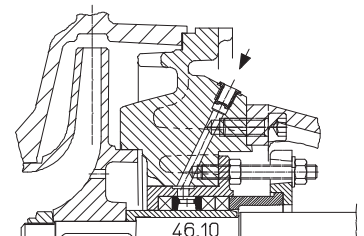

Shaft seal
Code 051 (optional)

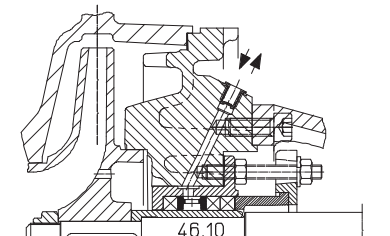

SECTIONAL DRAWING AND NOMENCLATURE

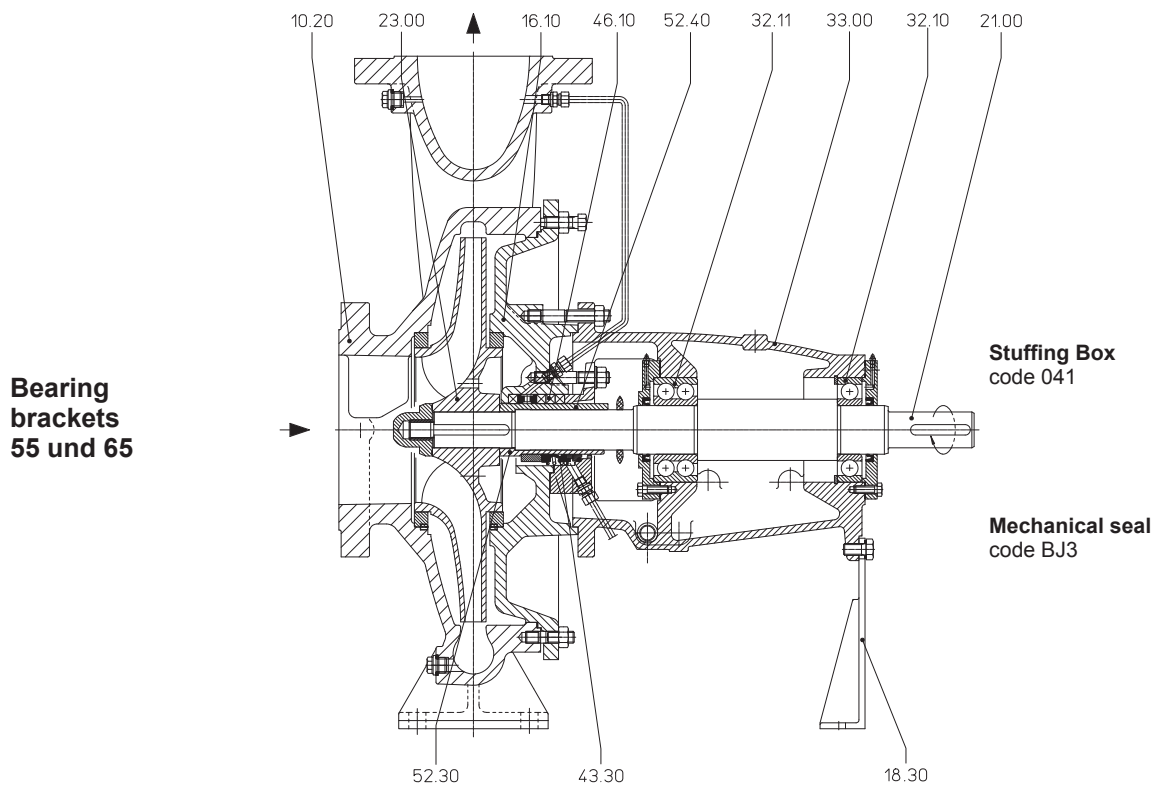

10.20	volute casing	23.00	impeller	43.30	mechanical seal
16.10	casing cover	32.10	ball bearing	46.10	stuffing box
18.30	support foot	32.11	ball bearing	52.30	shaft sleeve (mechanical seal)
21.00	shaft	33.00	bearing bracket	52.40	shaft sleeve (stuffing box)

Shaft seals

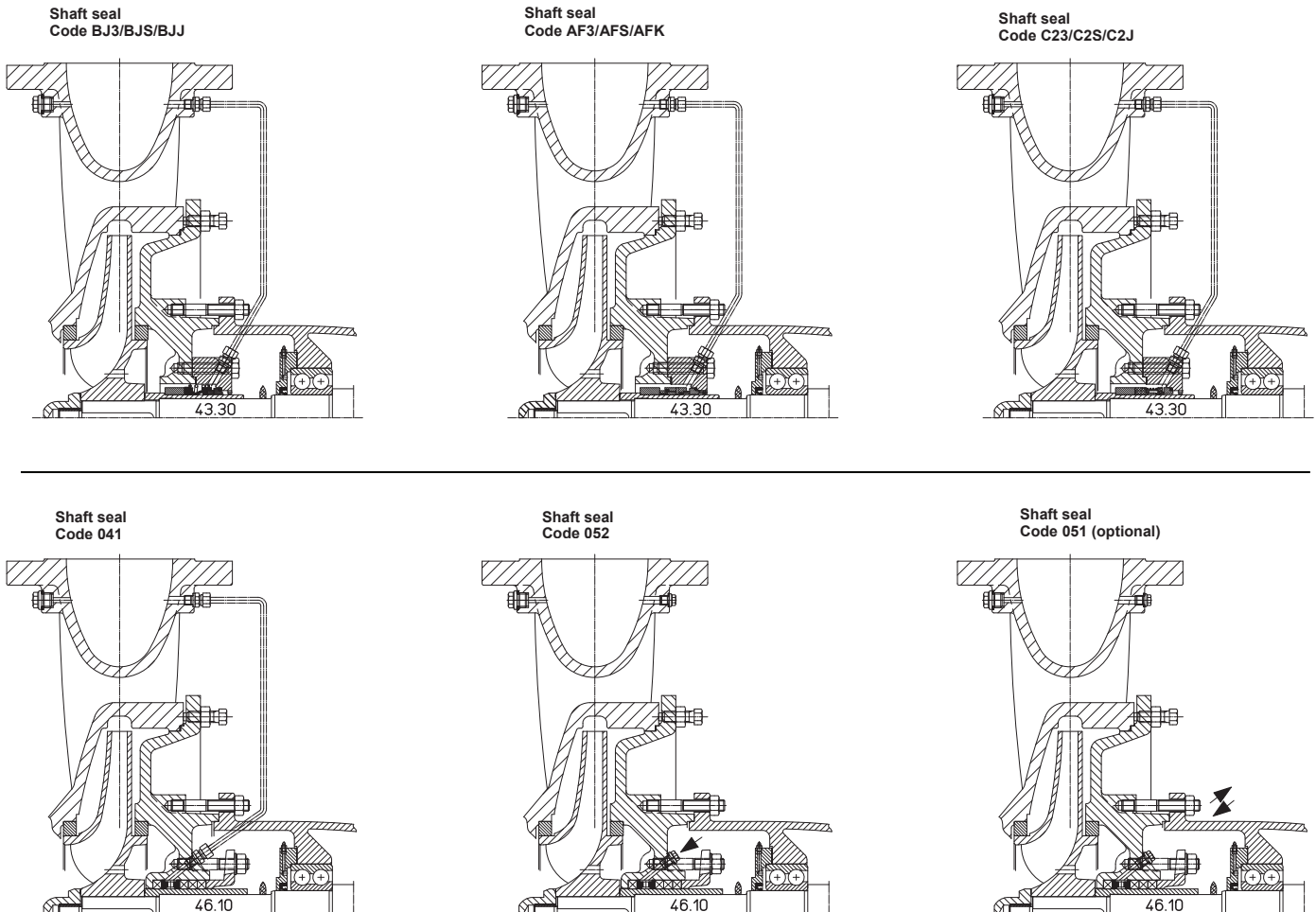

Performance Graph 50 Hz

n = 1450 rpm

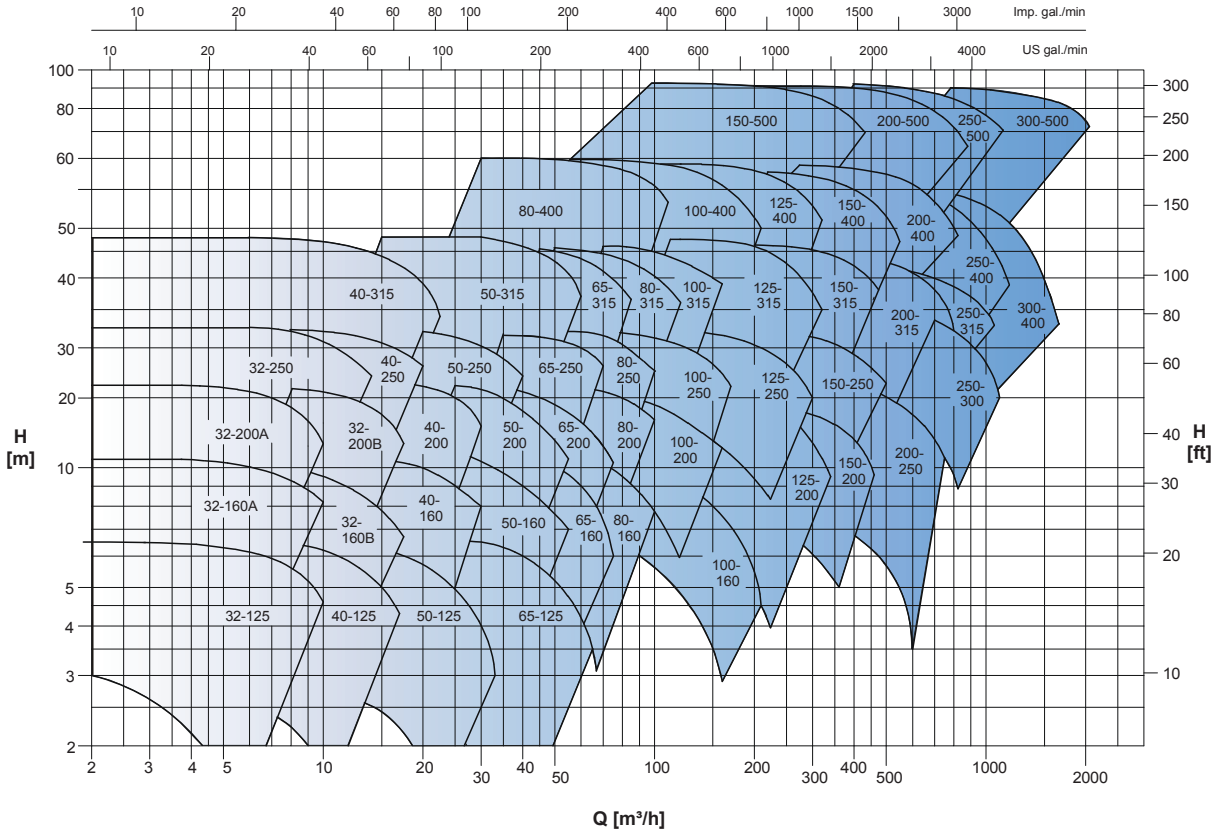

n = 2900 rpm

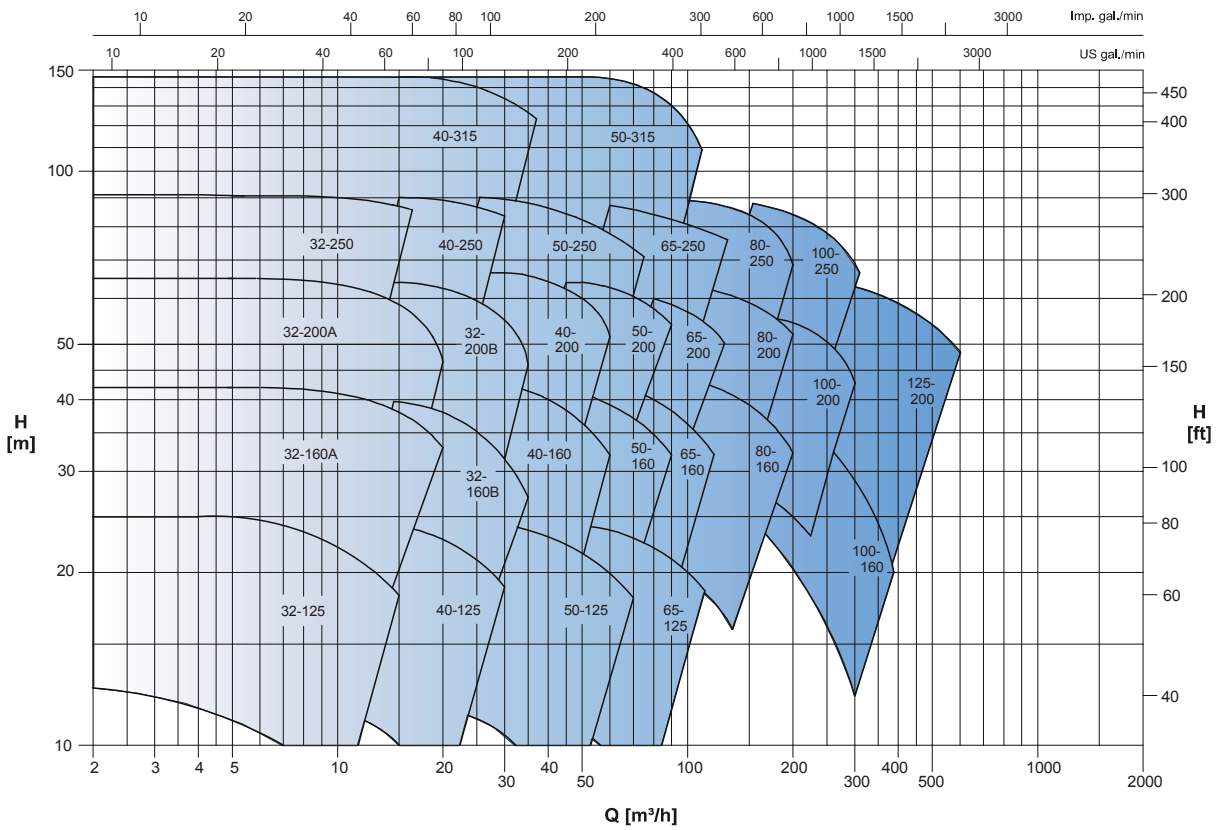

Performance Graph 60 Hz

n = 1750 rpm

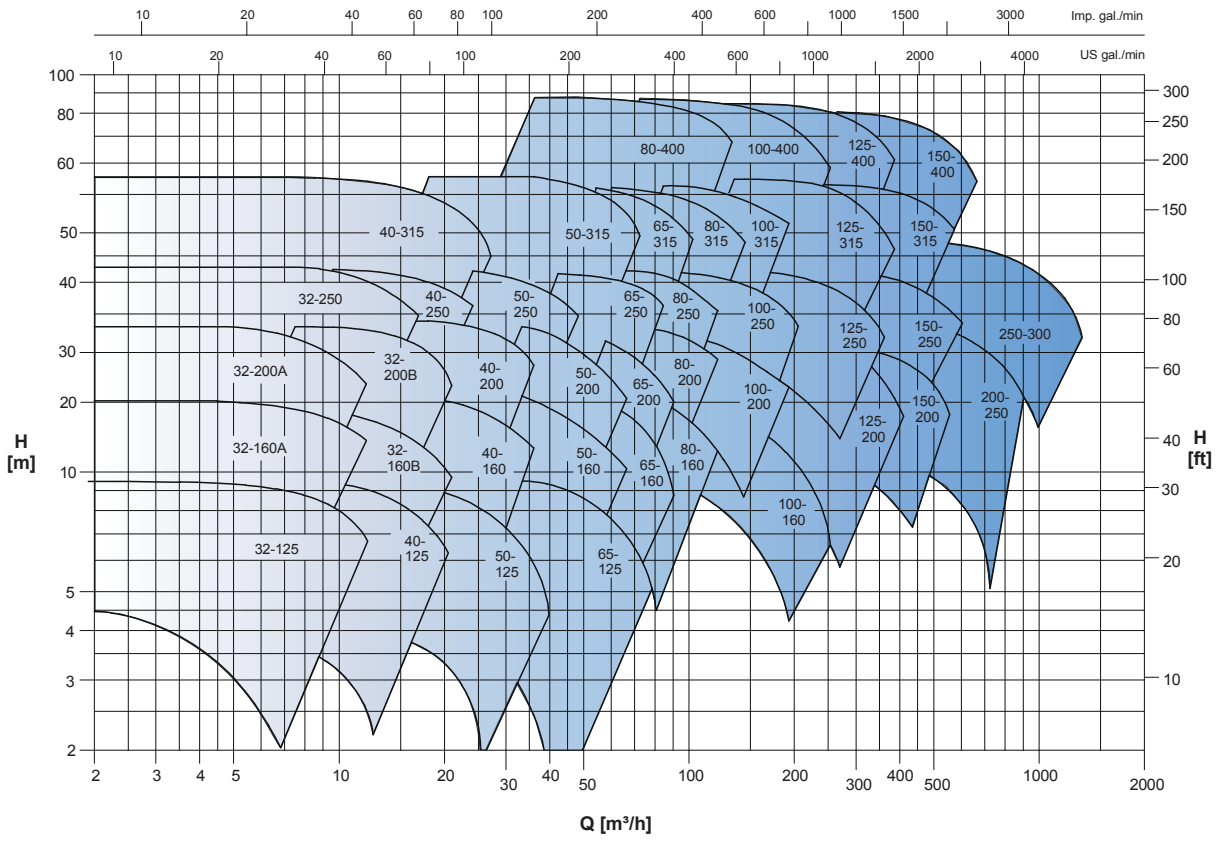

n = 3500 rpm

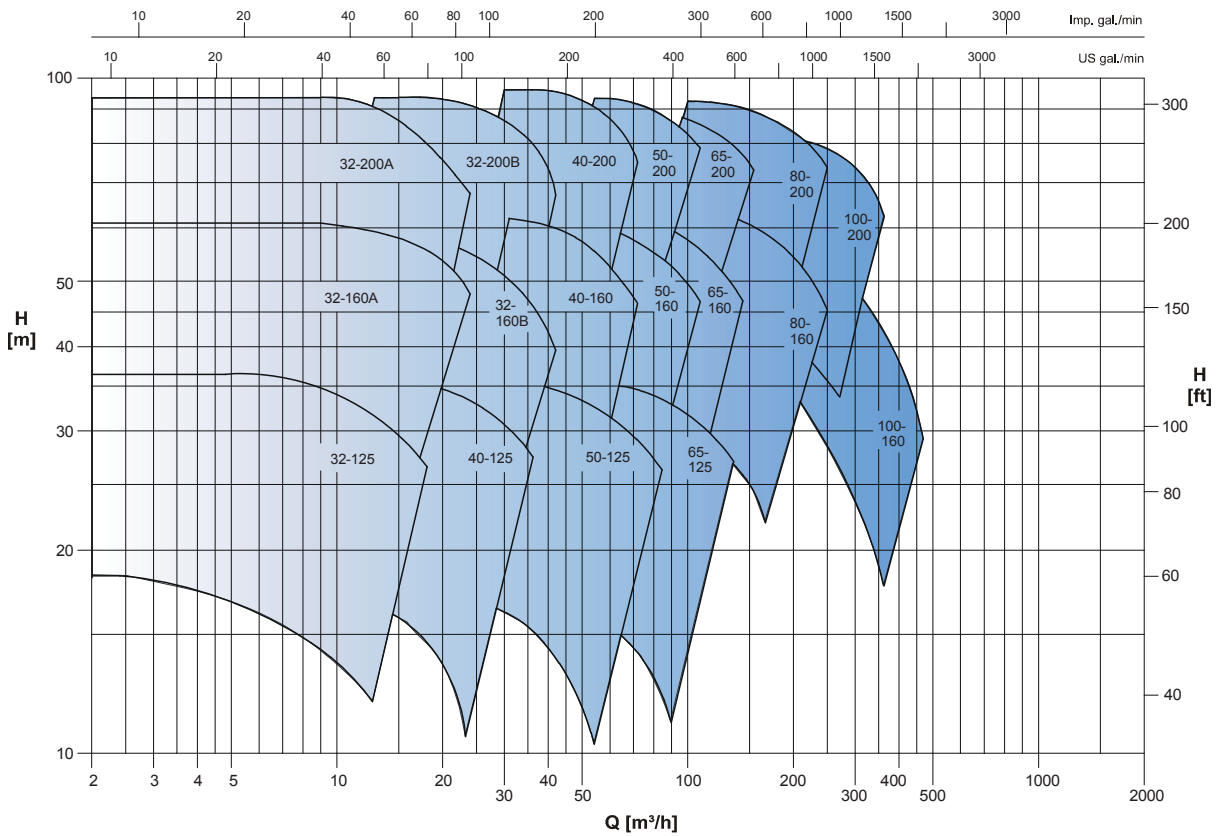
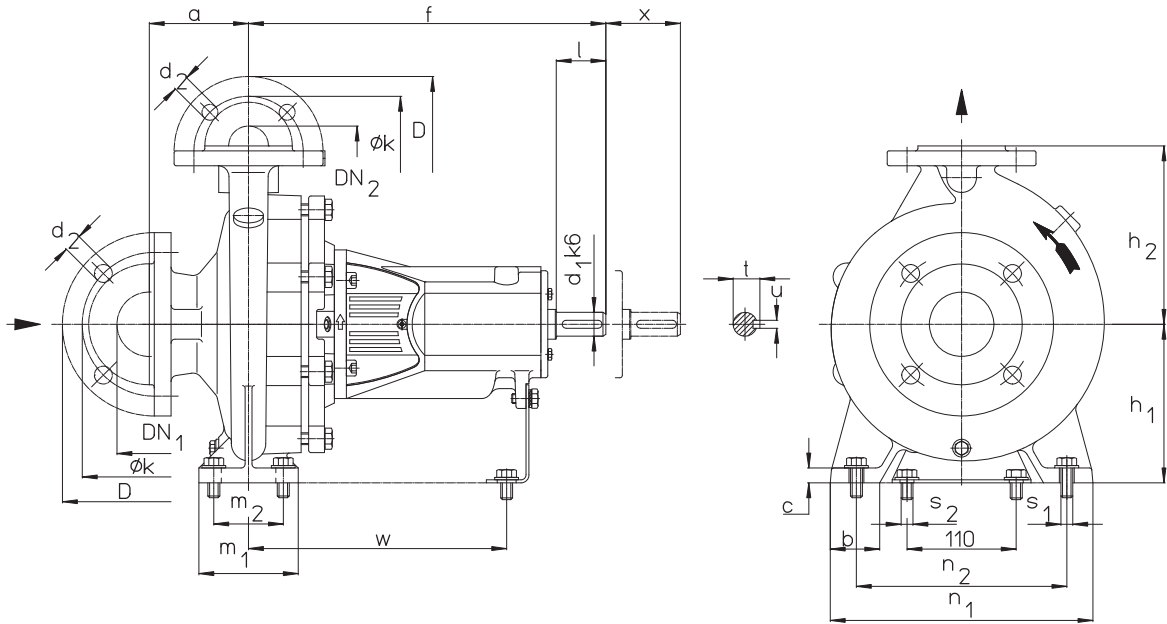

Table of Dimensions – bearing brackets 25, 35 and 45



Dimensions in mm

Size-	Bearing bracket	Pump dimensions						Foot dimensions								Shaft end					
		DN ₂	DN ₁	a	f	h ₁	h ₂	b	c	m ₁	m ₂	n ₁	n ₂	s ₁ *	s ₂ *	w	x	d ₁	l	t	u
32125	25	32	50	80	360	112	140	50	15	100	70	190	140	M12	M12	260	100	24	50	27	8
32160						132	160					240	190								
32200						160	180					265	212								
32250 ¹⁾						180	225					320	250								
40125	25	40	65	80	360	112	140	50	15	100	70	210	160	M12	M12	260	100	24	50	27	8
40160				132		160	240					190									
40200				160		180	265					212									
40250				180		225	320					250									
40315 ¹⁾	35			125	470	225	250	65	18	125	95	345	280			340		32	80	35	10
50125	25	50	65	100	360	132	160	50	15	100	70	240	190	M12	M12	260	100	24	50	27	8
50160						160	180					265	212								
50200						180	200					320	250								
50250						180	225					320	250								
50315 ¹⁾	35			125	470	225	280	65	17	125	95	345	280			340		32	80	35	10
65125	25	65	80	100	360	160	180	65	15	125	95	280	212	M12	M12	260	100	24	50	27	8
65160						200	225					320	250								
65200						180	225					320	250								
65250						200	250					360	280								
65315	35			125	470	225	280	80	18	160	120	400	315	M16		340	140	32	80	35	10
80160	25	80	100	125	360	180	225	65	15	125	95	320	250	M12	M12	260	140	24	50	27	8
80200	180				250	345	280														
80250	200				280	400	315														
80315	250				315	400	315														
80400 ¹⁾	45			125	530	280	355	100		160	120	435	355	M16		370		42	110	45	12
100160 ¹⁾	35	100	125	125	470	200	280	80	18	160	120	360	280	M16	M12	340	140	32	80	35	10
100200				225		315	400					315									
100250				250		315	400					315									
100315				250		315	400					315									
100400	45			125	530	280	355	100		200	150	500	400	M20		370		42	110	45	12
125200 ¹⁾	35	125	150	140	470	250	315	80	18	160	120	400	315	M16	M12	340	140	32	80	35	10
125250						280	355					400	315								
125315	45	125	150	140	530	280	315	100	18	200	150	500	400	M20	M12	370	140	42	110	45	12
125400						315	400					400	315								
150200 ¹⁾	35	150	200	160	470	280	400	100	20	200	150	550	450	M20	M12	340	140	32	80	35	10
150250 ¹⁾						315	450					400	315								
150315	45	150	200	160	530	315	450	100	18	200	150	550	450	M20	M12	370	140	42	110	45	12
150400						315	450					400	315								
200250 ¹⁾	45	200	200	160	590	280	400	100	22	200	150	500	400	M20	M12	430	180	42	110	45	12

¹⁾ Transnorm pump sizes, not included in DIN 24255 / EN 733

* Slots suitable for bolts with dimensions indicated. Bolts are not included in the bare shaft pump standard scope of supply. Flanges drilled according to ANSI 150 on request.

Table of Dimensions – bearing brackets 55 and 65

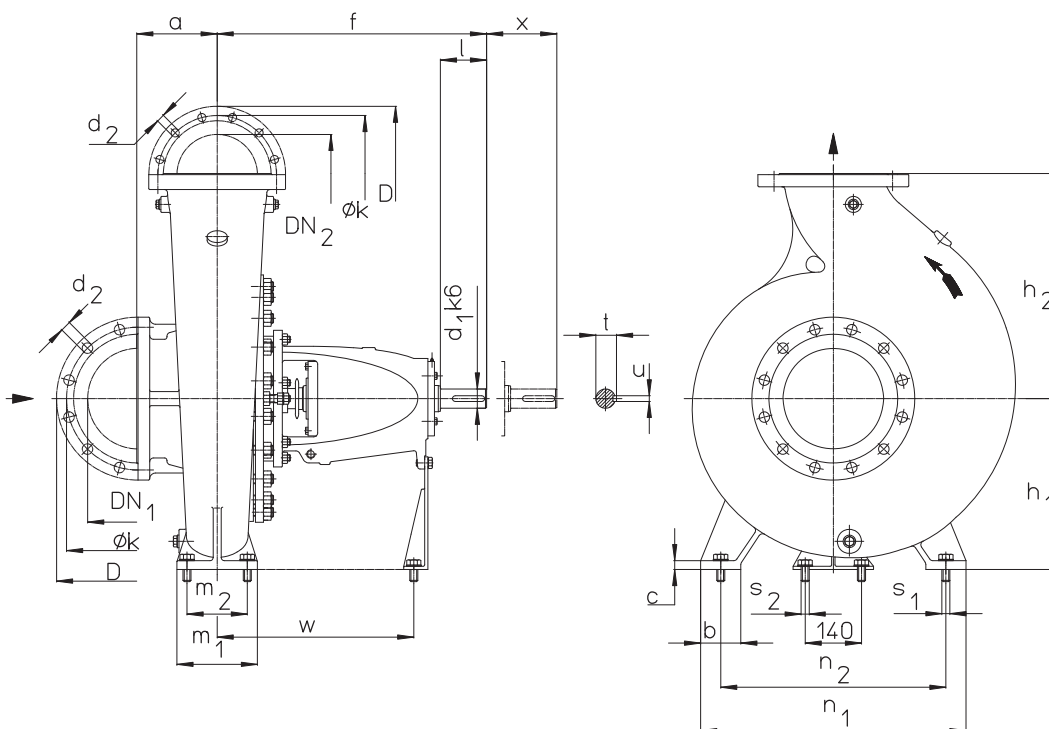

Dimensions in mm

Size-	Bearing bracket	Pump dimensions						Foot dimensions								Shaft end					
		DN ₂	DN ₁	a	f	h ₁	h ₂	b	c	m ₁	m ₂	n ₁	n ₂	s ₁ *	s ₂ *	w	x	d ₁	l	t	u
150500 ¹⁾	55	150	200	180	670	400	500	100	22	200	150	640	540	M20	M16	489	180	50	115	53,5	14
200315 ¹⁾	55	200	250	200	670	355	450	100	22	200	150	550	450	M20	M16	489	180	50	115	53,5	14
200400 ¹⁾	55	200	250	180	670	355	500	100	22	200	150	550	450	M20	M16	489	180	50	115	53,5	14
200500 ¹⁾	55	200	250	200	670	425	560	100	22	200	150	660	560	M20	M16	489	180	50	115	53,5	14
250300 ¹⁾	55	250	300	305	655	425	550	120	28	240	190	700	600	M20	M16	474	180	50	115	53,5	14
250315 ¹⁾	55	250	300	250	670	375	560	120	28	240	190	620	520	M20	M16	489	180	50	115	53,5	14
250400 ¹⁾	65	250	300	250	720	400	600	120	29	240	190	700	600	M20	M16	508	180	60 ²⁾	145	64	18
250500 ¹⁾	65	250	300	250	720	450	670	120	32	240	190	750	650	M20	M16	503	180	60 ²⁾	145	64	18
300400 ¹⁾	65	300	350	300	720	425	670	120	30	250	190	760	660	M24	M16	508	180	60 ²⁾	145	64	18
300500 ¹⁾	65	300	350	300	720	480	670	140	32	250	190	840	720	M24	M16	508	180	60 ²⁾	145	64	18

¹⁾ Transnorm pump sizes, not included in DIN 24255 / EN 733. Flanges drilled according to ANSI 150 on request.

²⁾ For these sizes the clearance corresponds to M6.

* Slots suitable for bolts with dimensions indicated. Bolts are not included in the bare shaft pump standard scope of supply.

Flange connections

DN ₂ /DN ₁	to DIN 2501 PN 16														to DIN 2501 PN 10			
	32	40	50	65	80	100	125	150	200	250	300	350	400	100	125	150	200	
D	140	150	165	185	200	220	250	285	340	405	460	520	580	220	250	285	340	
k	100	110	125	145	160	180	210	240	295	355	410	470	525	180	210	240	295	
d ₂ x number	18x4	18x4	18x4	18x4	18x8	18x8	18x8	22x8	22x12	26x12	26x12	26x16	30x16	18x8	18x8	22x8	22x8	

Connections for bearing brackets 25, 35 and 45

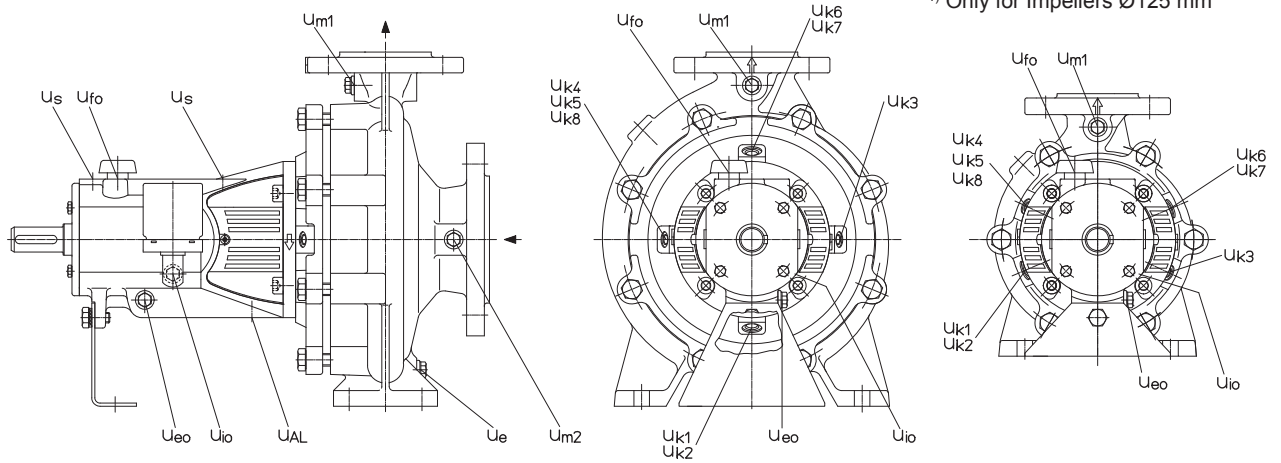

u_{m1} : Pressure gauge. Only available on request
u_{m2} : Pressure gauge. Only available on request
u_e : Drainage
u_{eo} : Oil drainage
u_{io} : Constant level oiler
u_{fo} : Oil filling
u_{AL} : Drainage for leakage. Threaded hole only available on request
u_s : Sensor

u_{k1} : Quench Inlet
u_{k2} : Heating Inlet
u_{k3} : 051 Inlet (Stuffing box)
u_{k4} : 052 External sealing (stuffing box)
u_{k5} : External Flushing
u_{k6} : Quench Outlet
u_{k7} : Heating Outlet
u_{k8} : 051 Outlet (Stuffing box)

Size	u _{m1}	u _{m2}	u _e	u _{eo}	u _{io}	u _{fo}	u _{AL}	u _s	u _{k1}	u _{k2}	u _{k3}	u _{k4}	u _{k5}	u _{k6}	u _{k7}	u _{k8}
32125 ¹⁾																
32160																
32200																
32250																
40125 ¹⁾																
40160																
40200			G 1/4													
40250			G 1/4													
40315			G 1/4													
50125 ¹⁾																
50160																
50200													G 1/8			
50250													G 1/8			
50315													G 1/8			
65125 ¹⁾																
65160																
65200																
65250																
65315																
80160	G 1/4			G 1/4		∅15,65	∅13	M 8								
80200	G 1/4			G 1/4		∅15,65	∅13	M 8								
80250	G 1/4			G 1/4		∅15,65	∅13	M 8								
80315	G 1/4			G 1/4		∅15,65	∅13	M 8								
80400	G 1/4			G 1/4		∅15,65	∅13	M 8								
100160														G 1/4		
100200														G 1/8		
100250			G 3/8											G 1/8		
100315			G 3/8											G 1/8		
100400			G 3/8											G 1/4		
125200														G 1/8		
125250														G 1/8		
125315														G 1/4		
125400														G 1/4		
150200														G 1/8		
150250														G 1/8		
150315														G 1/8		
150400														G 1/8		
200250														G 1/4		

Certain construction sizes do not correspond in all details to the drawing.

Connections for bearing brackets 55 and 65

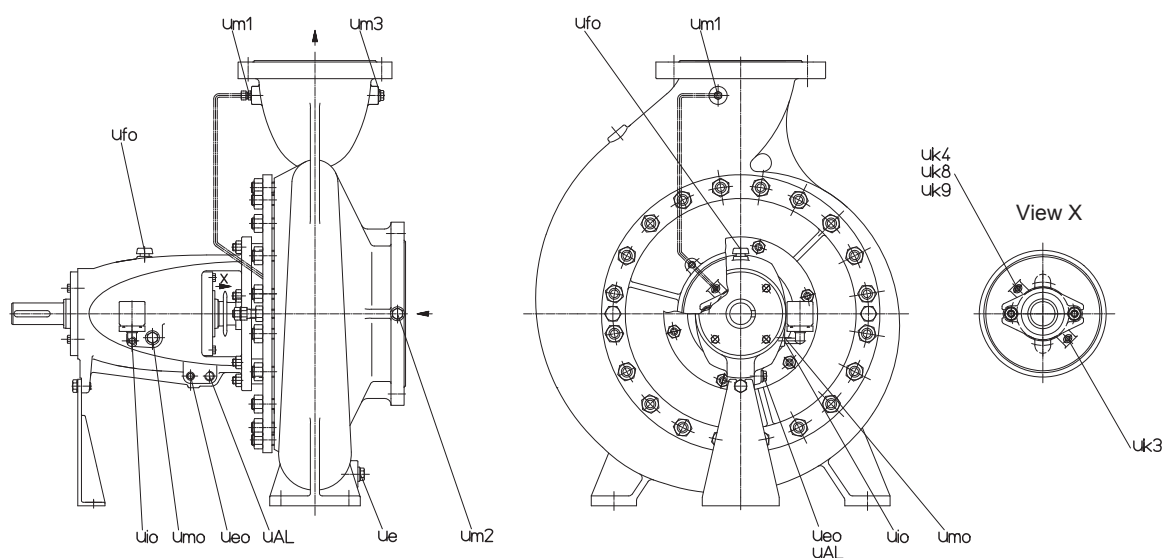

U_{m1} : Self sealing connection
 U_{m2} : Pressure/vacuum gauge Only available on request
 U_e : Drainage
 U_{eo} : Oil drainage
 U_{io} : Constant level oiler
 U_{fo} : Oil filling
 U_{AL} : Drainage for leakage

U_{m3} : Pressure gauge connection
 U_{k3} : 051 Inlet (Stuffing box)
 U_{k4} : 052 External sealing (Stuffing box)
 U_{k8} : 051 Outlet (Stuffing box)
 U_{mo} : Oil level control
 U_{k9} : 041 Inlet (Stuffing box)

Size	U _{m1}	U _{m2}	U _e	U _{eo}	U _{io}	U _{fo}	U _{AL}	U _{m3}	U _{k3}	U _{k4}	U _{k8}	U _{mo}	U _{k9}
150500													
200315													
200400													
200500													
250300													
250315	G1/4	G1/2	G1/2	G1/4	G1/4	∅ 20	G1/2	G1/2	G1/4	G1/4	G1/4	G3/4	G1/4
250400													
250500													
300400													
300500													

Foundation plan (bearing brackets 25, 35 and 45)

n = 1450 rpm

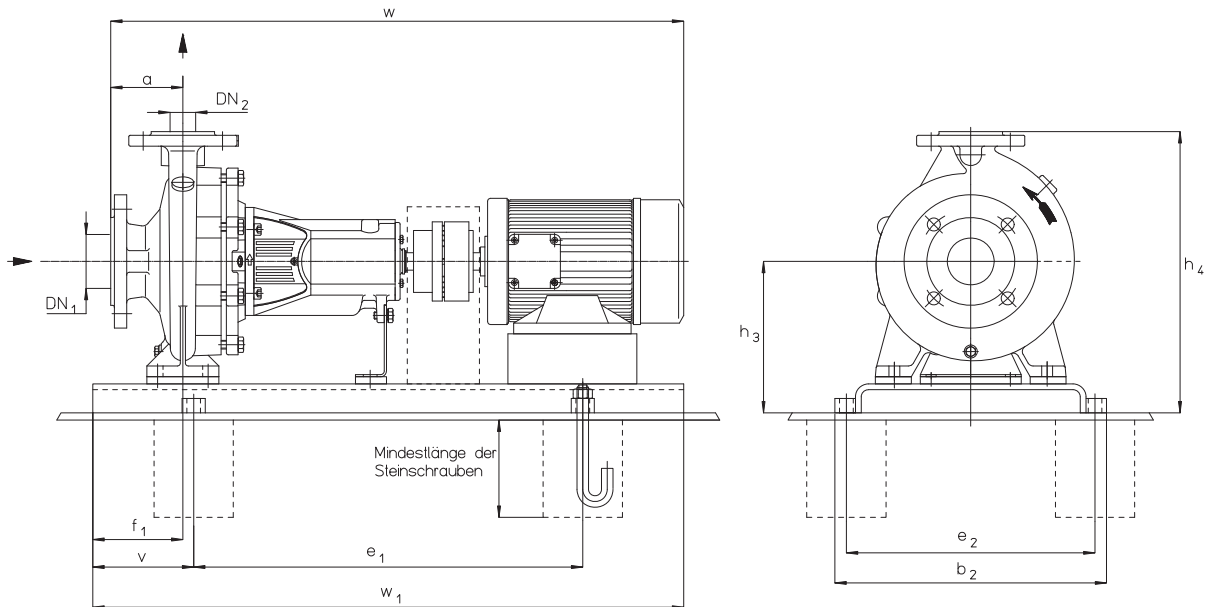

Dimensions in mm

Tolerances for welded parts acc. to DIN 8570 B

Size	Motor		Base plate No.	Coupling	Weight kg		DN ₂	DN ₁	a	b ₂	e ₁	e ₂	v	f ₁	h ₃	h ₄	w*	w ₁	Rag bolt			
	size	kW			Pump	unit.																
32125	71	0,25	S241		31	50				330	480	290			177	317	683	730	M16x200			
	71	0,37			33	65									197	357	683					
32160	80	0,55	S301	B68				80	390	480	350	125	60					730	M16x200			
	80	0,55																		67	717	717
32200	80	0,75	S301	B68				80	390	480	350	125	60					730	M16x200			
	90S	1,10																		70	717	717
32250	80	0,75	S383	B80				100	490	600	440	160	75					920	M20x400			
	90S	1,10																		103	737	795
	90L	1,50																		106	795	795
	100L	2,20																		109	836	836
40125	71	0,37	S241						330	480	290			177	317	683	730	M16x200				
	80	0,55												62	717	683						
40160	71	0,37	S301	B68				80	390	480	350	125	60					730	M16x200			
	80	0,55																		62	683	717
	80	0,75																		66	717	717
	90S	1,10																		69	775	737
40200	80	0,55	S301	B68				100	490	600	440	160	75					920	M20x400			
	90S	1,10																		75	737	795
	90L	1,50																		80	795	795
40250	80	0,55	S383	B80				100	490	600	440	160	75					920	M20x400			
	90S	1,10																		106	795	795
	90L	1,50																		109	836	836
	100L	2,20																		119	836	836
40315	100L	3,00	S383	B80				125	490	600	440	160	75					920	M20x400			
	112M	4,00																		121	836	836
40315	112M	4,00	S434	B95				125	540	660	490	170						1000	M20x400			
	132S	5,50																		147	971	992
50125	71	0,37	S301	B68					330	480	290			177	317	683	730	M16x200				
	80	0,55												62	717	683						
50160	80	0,75	S301	B68				100	390	480	350	125	60					730	M16x200			
	80	0,55																		66	717	717
	90S	1,10																		75	737	737
50200	80	0,75	S301	B68				100	390	480	350	125	60					730	M16x200			
	90S	1,10																		81	737	737
	90L	1,50																		84	795	795
50250	100L	2,20	S342	B80				100	450	540	400	140						820	M20x400			
	90L	1,50																		97	836	836
	100L	2,20																		114	836	836
	100L	3,00																		123	857	857
50315	112M	4,00	S383	B80				100	490	600	440	160	75					920	M20x400			
	132M	4,00																		125	836	836
	132S	5,50																		131	857	857
50315	132S	5,50	S434	B95				125	540	660	490	170						1000	M20x400			
	132M	7,50																		171	1068	1094
65125	80	0,55	S342	B68					330	480	290			177	317	683	730	M16x200				
	80	0,75												62	717	683						
65160	80	0,75	S342	B68				100	450	540	400	140	60					820	M20x400			
	90L	1,50																		88	737	737
	100L	2,20																		88	737	737
	100L	2,20																		95	795	795

* Motor protection type IP 55, dimensions depend on the motor manufacturer. Dimensions listed are taken from the SIEMENS catalogue.

Size	Motor		Base plate No.	Coupling	Weight kg		DN ₂	DN ₁	a	b ₂	e ₁	e ₂	v	f ₁	h ₃	h ₄	w*	w ₁	Rag bolt														
	size	kW			Pump	unit																											
65200	90S	1,10	S383	B68	45	105	65	80	100	490	600	440	160	75	260	485	795	920	M20x400														
	90L	1,50															795																
	100L	2,20		836																													
	100L	3,00		836																													
	112M	4,00		857																													
65250	100L	2,20	S434	B80	70	158	65	80	100	540	660	490	170	90	280	530	946	1000	M20x400														
	100L	3,00															946																
	112M	4,00		967																													
	132S	5,50		1043																													
65315	132S	5,50	S605	B95	92	236	65	80	125	730	740	670	190	90	300	550	1068	1120	M24x400														
	132M	7,50															1068																
	160M	11,00															1094																
	160L	15,00															1186																
	160L	15,00															1248																
80160	80	0,75	S383	B68	43	100	80	100	125	490	600	440	160	75	260	485	762	920	M20x400														
	90S	1,10															820																
	90L	1,50															820																
	100L	2,20															861																
	100L	3,00															861																
	80200	90L		1,50	S434	B80											60			125	80	100	125	540	660	490	170	90	300	580	930	1000	M20x400
		100L		2,20																											971		
		100L		3,00																											971		
		112M		4,00																											992		
		132S		5,50																											1068		
	80250	100L		3,00	S605	B80											75			197	80	100	125	730	740	670	190	90	300	580	971	1120	M24x400
112M		4,00	992																														
132S		5,50	1068																														
132M		7,50	1094																														
132S		5,50	1068																														
80315	132M	7,50	S605	B95	95	239	80	100	125	730	740	670	190	90	350	665	1094	1250	M24x400														
	160M	11,00															1186																
	160L	15,00															1248																
80400	160M	11,00	S486	B95	143	322	80	125	140	610	840	550	205	90	380	735	1247	1250	M24x400														
	160L	15,00		B110													340																
	180M	18,50		B110													361																
	180L	22,00		B110													376																
	200L	30,00		B125													424																
	200L	30,00		B125													424																
100160	100L	2,20	S434	B80	78	166	80	100	125	540	660	490	170	90	280	560	971	1000	M20x400														
	100L	3,00															971																
	112M	4,00															992																
	132S	5,50															1068																
100200	100L	2,20	S434	B80	70	158	80	100	125	540	660	490	170	90	280	560	971	1000	M20x400														
	100L	3,00															971																
	112M	4,00															992																
	132S	5,50															1068																
	132M	7,50															1094																
100250	112M	4,00	S605	B80	85	213	80	100	125	730	740	670	190	90	325	605	1007	1120	M24x400														
	132S	5,50															1083																
	132M	7,50															1109																
	160M	11,00															1201																
100315	160M	11,00	S486	B110	104	281	80	100	140	610	840	550	205	90	350	665	1201	1250	M24x400														
	160L	15,00															1263																
	180M	18,50															1325																
	180L	22,00															1325																
100400	160L	15,00	S606	B95	177	402	80	100	140	730	840	670	205	110	380	735	1262	1400	M24x400														
	180M	18,50		B110													423																
	180L	22,00		B110													438																
	200L	30,00		B125													486																
	225S	37,00		B140													548																
	225M	45,00		B140													569																
125200	132M	7,50	S605	B95	100	256	80	100	140	730	740	670	190	90	350	665	1109	1120	M24x400														
	160M	11,00															1277																
	160L	15,00															1296																
125250	132M	7,50	S605	B95	102	258	80	100	140	730	740	670	190	90	350	705	1109	1120	M24x400														
	160M	11,00															1279																
	160L	15,00															1298																
125315	160L	15,00	S606	B95	151	375	125	150	140	730	840	670	205	110	380	735	1262	1250	M24x400														
	180M	18,50															B110			396													
	180L	22,00		B110													411																
	200L	30,00		B125													459																
	225S	37,00		B140													520																
125400	200L	30,00	S606	B125	188	498	80	100	140	730	840	670	205	110	415	815	1444	1400	M24x400														
	225S	37,00															B140			559													
	225M	45,00															B140			580													
	250M	55,00															B160			793													
	280S	75,00															B180			1047													
	280S	75,00															B180			1047													
150200	132M	7,50	S605	B95	123	295	150	200	160	730	740	670	190	110	380	780	1129	1120	M24x400														
	160M	11,00															1221																
	160L	15,00															1283																
	180M	18,50															1345																
150250	160L	15,00	S606	B110	128	340	150	200	160	730	840	670	205	110	380	780	1283	1250	M24x400														
	180M	18,50															1345																
	180L	22,00															B125			1345													
	200L	30,00															B140			1403													

* Motor protection type IP 55, dimensions depend on the motor manufacturer. Dimensions listed are taken from the SIEMENS catalogue.

Size	Motor		Base plate No.	Coupling	Weight kg		DN ₂	DN ₁	a	b ₂	e ₁	e ₂	v	f ₁	h ₃	h ₄	w*	w ₁	Rag bolt		
	size.	kW			Pump	unit															
150315	180L	22,00	S606	B110	170	431	150	200	160	730	840	670	230	110	380	780	1406	1250	M24x400		
	200L	30,00		B125		479											1464				
	225S	37,00		B140		540											1501				
	225M	45,00	S607	B160		561											1400	1501			
	250M	55,00		B140		598												1624			
150400	225M	45,00	180x73x14	B180	205	774	1460	680	170	200	170	200	455	905	415	865	1501	1624	1699	1800	M16x200
	250M	55,00		B160		811									1699						
	280S	75,00		B180		1065									1699						
	280M	90,00		B180		1117									1699						
200250	160L	15,00	S607	B95	230	471	200	200	160	730	940	670	230	185	380	780	1342	1400	M24x400		
	180M	18,50		B110		492											1466				
	180L	22,00		B110		507											1466				
	200L	30,00		B125		555											1524				

* Motor protection type IP 55, dimensions depend on the motor manufacturer.
Dimensions listed are taken from the SIEMENS catalogue.

Foundation plan (bearing brackets 55 and 65)

n = 1450 rpm

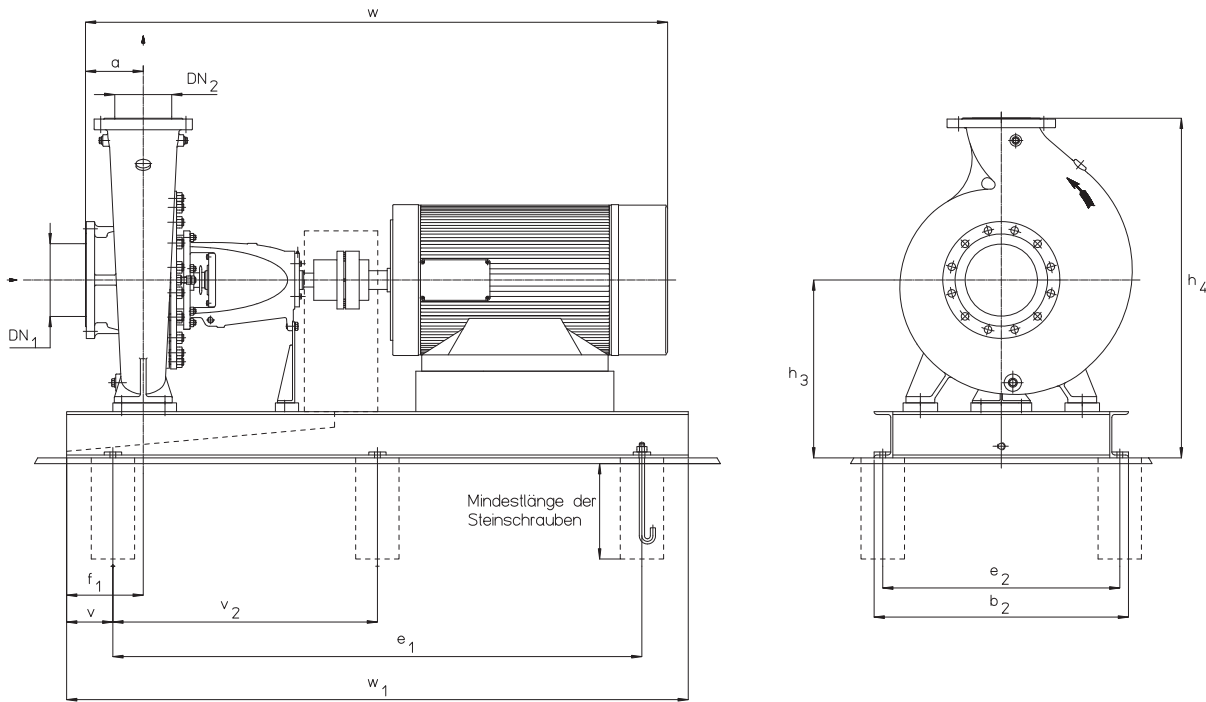

Dimensions in mm

Tolerances for welded parts acc. to DIN 8570 B

Size	Motor		Base plate No.	Coupling	Weight kg		DN ₂	DN ₁	a	b ₂	v	e ₁	e ₂	v ₂	f ₁	h ₃	h ₄	w*	w ₁	Rag bolt																	
	size	kW			Pump	unit																															
150500	180L	22	167x81x12	B125	335	674	150	200	180	810	170	1330	760	665	235	550	1050	1566	1670	M16x200																	
	200L	30	174x82x14	B140																	754																
	225S	37	178x82x14																		817																
	225M	45		845																																	
	250M	55	190x82x14	B160																	955																
	280S	75	198x82x14	B180																	1136																
	280M	90		1186																																	
	315S	110	212x83x16	B200																	1397																
	315M	132																			1477																
	315L	160	226x83x16																		1635																
	315L	200																			1775																
	315	250	238x87x16																		B225	1605															
200315	180L	22	169x72x12	B125	310	659			200	720	170	1350	670	675	255	505	955	1586	1690	M16x200																	
	200L	30	176x73x14	B140																	712																
	225S	37	180x73x14																		777																
	225M	45		805																																	
	250M	55	192x73x14	B160																	915																
	280S	75	200x74x14	B180																	1095																
	200400	180L	22	167x72x12																	B125	340	666			180	720	170	1330	670	665	235	505	1005	1566	1670	M16x200
		200L	30	174x73x14																	B140																
225S		37	178x73x14	807																																	
225M		45		835																																	
250M		55	190x73x14	B160	945																																
280S		75	198x74x14	B180	1125																																
280M		90		1175																																	
315S		110	212x82x16	B200	1400																																
315M		132			1480																																
315L		160	226x82x16		1635																																
315L		200			1775																																
315		250	238x87x16		B225	1610																															
200500	225M	45	180x84x14	B140	395	915			200	840	190	1420	710	260	595	1155	1681	1800	M16x200																		
	250M	55	192x84x14	B160																1025																	
	280S	75	200x84x14	B180																1205																	
	280M	90		1255																																	
	315S	110	214x85x16	B200																1465																	
	315M	132																		1545																	
	315L	160	228x85x16																	1700																	
	315L	200																		1840																	
	315	250	240x87x16																	B225	1665																
	315	315		B250																1865																	
	355	355	264x98x18																	1965																	
	200500	315S	110	214x85x16																B200	395	1465			200	850	210	1720	860	265	615	1175	2014	2140	M18x200		
315M		132		1545																																	
315L		160	228x85x16	1700																																	
315L		200		1840																																	
315		250	240x87x16	B225	1665																																
315		315		B250	1865																																
355		355	264x98x18		1965																																

* Motor protection type IP 55, dimensions depend on the motor manufacturer. Dimensions listed are taken from the SIEMENS catalogue.

Size	Motor		Base plate No.	Coupling	Weight kg		DN ₂	DN ₁	a	b ₂	v	e ₁	e ₂	v ₂	F ₁	h ₃	H ₄	w*	w ₁	Rag bolt						
	size	kW			Pump.	unit																				
250300	225S	37	189x88x14	B140	416	894	250	300	305	880	190	1510	830	755	365	595	1145	1771	1890	M16x200						
	225M	45				922					190	1771		1890												
	250M	55	201x88x14	B160		1037					210	1590		795				1894	2010							
	280S	75	209x88x14	B180		1217					210	1670		835				1969	2090							
250315	200L	30	181x80x14	B125	424	842	250	300	250	800	190	1430	750	715	310	545	1105	1694	1810	M16x200						
	225S	37	185x80x14	B140		902					190	1470		735				1731	1850							
	225M	45				930					190							1731								
	250M	55	197x80x14	B160		1045					190	1590		795				1854	1970							
	280S	75	205x80x14	B180		1225					210	1630		815				1929	2050							
	280M	90				1275					210							1929								
	315S	110	219x82x16	B200		1485					820	210		1770				760	885		315	565	1125	2064	2190	M18x200
	315M	132				1565					210							2064						2064		
250400	225S	37	190x88x14	B140	464	958	250	300	250	880	190	1520	830	760	310	570	1170	1781	1900	M16x200						
	225M	45				985					190			800				1781								
	250M	55	202x88x14	B160		1095					210	1600		840				1904	2020							
	280S	75	210x88x14	B180		1275					210	1680						1979	2100							
	280M	90				1325					210							1979								
	315S	110	224x89x16	B200		1540					230	1780		890				2114	2240							
	315M	132				1620					230							2114								
	315L	160	238x89x16	B225		1775					230	1920		960				2254	2380							
	315L	200				1915					230							2254								
	315	250	250x89x16	B250		1735					250	2000		1000				2374	2500							
	315	315				2135					250							2374								
	355	355	274x98x18			2040					980	270		2200				920	1100		320	610	1210	2599	2740	
250500	280S	75	210x93x14	B180	589	1407	250	300	250	930	210	1680	880	840	315	640	1310	1979	2100	M16x200						
	280M	90				1456					210			890				1979								
	315S	110	224x94x16	B200		1671					230	1780		960				2114	2240							
	315M	132				1755					230							2114								
	315L	160	238x94x16	B225		1910					230	1920		960				2254	2380							
	315L	200				2050					230							2254								
	315	250	250x94x16	B250		1860					250	2000		1000				2374	2500							
	315	315				2160					250							2374								
	355	355	274x98x18			2165					980	270		2200				920	1100		320	660	1330	2599	2740	
	355	400				2205					980	270						2599						2599		
300400	225M	45	195x94x14	B140	620	1150	300	350	300	940	190	1570	890	785	360	595	1265	1831	1950	M16x200						
	250M	55	207x94x14	B160		1260					210	1650		825				1954	2070							
	280S	75	215x94x14	B180		1442					210	1730		865				2029	2150							
	280M	90				1491					210							2029								
	315S	110	229x95x16	B200		1701					230	1830		915				2164	2290							
	315M	132				1785					230							2164								
	315L	160	243x95x16	B225		1945					250	1930		965				2304	2430							
	315L	200				2085					250							2304								
	315	250	255x95x16	B250		1892					250	2050		1025				2424	2550							
	315	315				2191					250							2424								
	355	355	279x98x18			2196					980	270		2250				920	1125		370	635	1305	2649	2790	
	355	400				2240					980	270						2649						2649		
300500	225M	45	195x102x14	B140	800	1270	300	350	300	1020	190	1570	970	785	360	650	1320	1831	1950	M16x200						
	250M	55	207x102x14	B160		1477					210	1650		825				1954	2070							
	280S	75	215x102x14	B180		1655					210	1730		865				2029	2150							
	280M	90				1711					210							2029								
	315S	110	229x103x16	B200		1925					230	1830		915				2164	2290							
	315M	132				2007					230							2164								
	315L	160	243x103x16	B225		2170					250	1930		965				2304	2430							
	315L	200				2313					250							2304								
	315	250	255x103x16	B250		2725					250	2050		1025				2424	2550							
	315	315				2939					250							2424								
	355	355	279x104x18	B280		3372					270							2649								
	355	400				3474					270							2649								
	355	500		A315		3689					270	2250		980				1125	370		690	1360		2649	2790	
	400	560				4302					290								2849							
	400	630	299x106x18			4524					1060	290		2410				1000	1205					2849	2990	
	400	710				4728					1060	290						2849						2849		

* Motor protection type IP 55, dimensions depend on the motor manufacturer. Dimensions listed are taken from the SIEMENS catalogue.

Foundation plan (bearing brackets 25, 35 und 45)

n = 2900 rpm

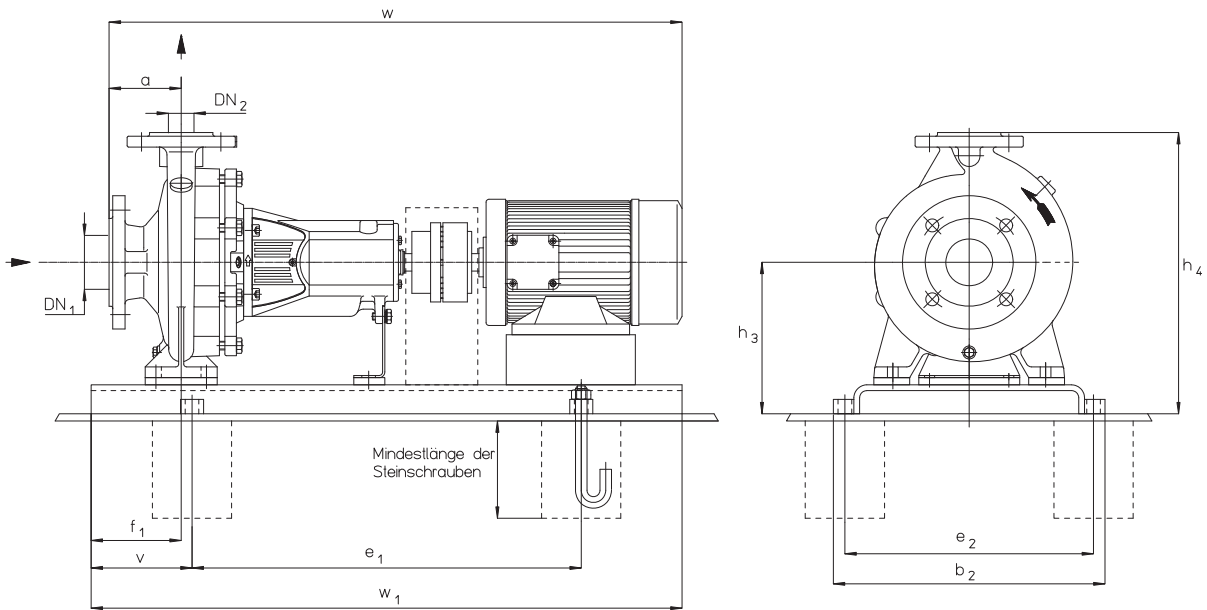

Dimensions in mm

Tolerances for welded parts acc. to DIN 8570 B

Size	Motor		Base plate No.	Coupling	Weight kg		DN ₂	DN ₁	a	b ₂	e ₁	e ₂	v	F ₁	h ₃	h ₄	w*	w ₁	Rag bolt	
	size	kW			Pump	unit														
32125	71	0,55	S241	B68	31	51	32	50	80	330	480	290	125	60	177	317	683	730	M16x200	
	80	0,75				52											717			
	80	1,10				54											717			
	90S	1,50				57											775			
	90L	2,20				74											775			
32160	90S	1,50	S301	B80	33	72	32	50	80	390	540	320	140	60	197	357	775	820	M16x200	
	90L	2,20	80			775														
	100L	3,00	S272			89				816										
	112M	4,00	96			837														
32200	90L	2,20	S301	B68	34	81	40	65	80	390	480	350	125	60	225	405	775	730	M16x200	
	100L	3,00	S272			90				816										
	112M	4,00	S303			97				837										
	132S	5,50				128				913										
	132S	7,50				138				913										
32250	132S	7,50	S383	B95	46	151	40	65	100	490	600	440	160	75	260	485	933	1000	M20x400	
	160M	11,00	S434			171				1051										
	160M	15,00	184			1051														
40125	80	1,10	S241	B68	28	64	40	65	80	330	480	290	125	60	177	317	717	730	M16x200	
	90S	1,50				67											775			
	90L	2,20				71											775			
	100L	3,00				S272											80			816
40160	90S	1,50	S301	B68	30	69	40	65	80	390	480	350	125	60	197	357	775	730	M16x200	
	90L	2,20	77			775														
	100L	3,00	S272			79				816										
	112M	4,00	S303			93				837										
	132S	5,50				B95				115							913			
40200	100L	3,00	S342	B80	36	115	40	65	100	450	540	400	140	60	240	420	836	820	M20x400	
	112M	4,00	S303			99				857										
	132S	5,50				122				933										
	132S	7,50				133				933										
	40250	160M	11,00			S383				B95							46			162
132S		7,50	151	933																
160M		11,00	S434	171	1051															
160M		15,00	184	1051																
50125	90S	1,50	S301	B68	30	69	50	65	100	390	480	350	125	60	197	357	795	730	M16x200	
	90L	2,20	77			795														
	132S	5,50	S303			B95											116			933
50160	90L	2,20	S301	B68	36	83	50	65	100	450	540	400	140	60	225	405	795	730	M16x200	
	100L	3,00	S342			B80											92			836
	112M	4,00	S303			99											857			
	132S	5,50				122											933			
	132S	7,50				133											933			
	50160	160M	11,00			S383											B95			36
160M		15,00	224	1113																

* Motor protection type IP 55, dimensions depend on the motor manufacturer. Dimensions listed are taken from the SIEMENS catalogue.

Size	Motor		Base plate No.	Coupling	Weight kg		DN ₂	DN ₁	a	b ₂	e ₁	e ₂	v	f ₁	h ₃	h ₄	w*	w ₁	Rag bolt								
	size	kW			Pump	unit																					
50200	100L	3,00	S342	B80	40	96	50	65	100	450	540	400	140	60	240	440	836	820	M20x400								
	112M	4,00	S303	B95													103			225	425	857					
	132S	5,50															126					933					
	132S	7,50															136					933					
	160M	11,00	S383	B95													167			240	440	1051					
160M	15,00	180	1051																								
50250	160M	15,00	S434	B110	50	188	75	100	540	660	490	170	75	260	485	1051	1000	M20x400									
	160L	18,50	S605													B125			228	280	505	1113					
	180M	22,00																	243			1175					
	200L	30,00																	303			1233					
65125	100L	3,00	S342	B80	33	98	65	80	100	450	540	400	140	60	240	420	836	820	M20x400								
	112M	4,00	S383	B95													104			490	600	440	160	857			
	132S	5,50															119							933			
	132S	7,50															130							933			
	65160	132S	5,50	S434													B95			39	125	75	100	540	660	490	170
132S		7,50	136		933																						
160M		11,00	165		1051																						
65200	160M	15,00	S605	B110	45	170	75	100	540	660	490	170	75	260	485	1051	1000	M24x400									
	160M	15,00														183			1051								
	160L	18,50														222			1113								
	180M	22,00														238			1175								
	200L	30,00														298			1233								
65250	160L	18,50	S435	B95	70	254	90	100	540	740	490	200	90	280	530	1223	1140	M20x400									
	180M	22,00	S486	B125												290			610	840	550	205	1285				
	200L	30,00														397							1343				
	200L	37,00														332							1343				
	225M	45,00	S607	357												730			940	670	230	325	575	1373	1400		
80160	132S	7,50	S383	B95	43	148	75	100	125	490	600	440	160	75	260	485	958	920	M20x400								
	160M	11,00	S434														B95			167	540	660	490	170	1076		
	160M	15,00																		181					1076		
	160L	18,50																		220					1138		
	180M	22,00	B110														235			505	1200						
80200	160M	15,00	S605	B95	60	226	90	100	125	730	740	670	190	75	280	530	1186	1120	M24x400								
	160L	18,50	S605	B95													244			550	1368	1368					
	180M	22,00															259						1310				
	200L	30,00															314						1368				
	200L	37,00	B125	338													550			1368							
80250	180M	22,00	S486	B110	75	293	90	100	125	610	840	550	205	90	300	580	1310	1250	M24x400								
	200L	30,00	S486	B125													348			730	940	670	230	1368			
	200L	37,00															372							1368			
	225M	45,00															402							1398			
	250M	55,00	B140	651													350			630	1528	1400					
100160	160L	18,50	S435	B95	78	263	90	125	125	540	740	490	200	90	280	580	1248	1140	M20x400								
	180M	22,00	B110	278													300			580	1368	1368					
	200L	30,00	S486	341																			1368				
	200L	37,00	B125	365													280			560	1248	1140					
100200	160L	18,50	S435	B95	70	254	90	125	125	540	740	490	200	90	300	580	1310	1250	M24x400								
	180M	22,00	S486	B125													269			610	840	550	205	1368			
	200L	30,00															332							1368			
	200L	37,00															357							1398			
	225M	45,00	S607	397													730			940	670	230	350	630	1543	1400	
100250	200L	30,00	S486	B125	85	358	90	140	140	610	840	550	205	90	325	605	1383	1250	M24x400								
	200L	37,00	382														1413										
	225M	45,00	S607														413			730	940	670	230	350	630	1543	1400
	250M	55,00	S609A														B160			661	744	1200	696	300	1643		
	280S	75,00																		827					1643		
	280M	90,00																		869					1643		
125200	250M	55,00	S607	B140	100	677	125	150	140	730	940	670	230	90	350	665	1543	1400	M24x400								
	280S	75,00	S609A	B160													842			1643							
	280M	90,00	884	1643																							

* Motor protection type IP 55, dimensions depend on the motor manufacturer.
Dimensions listed are taken from the SIEMENS catalogue.

Foundation plan for units with spacer type coupling (bearing brackets 25, 35 und 45)

n = 1450 rpm

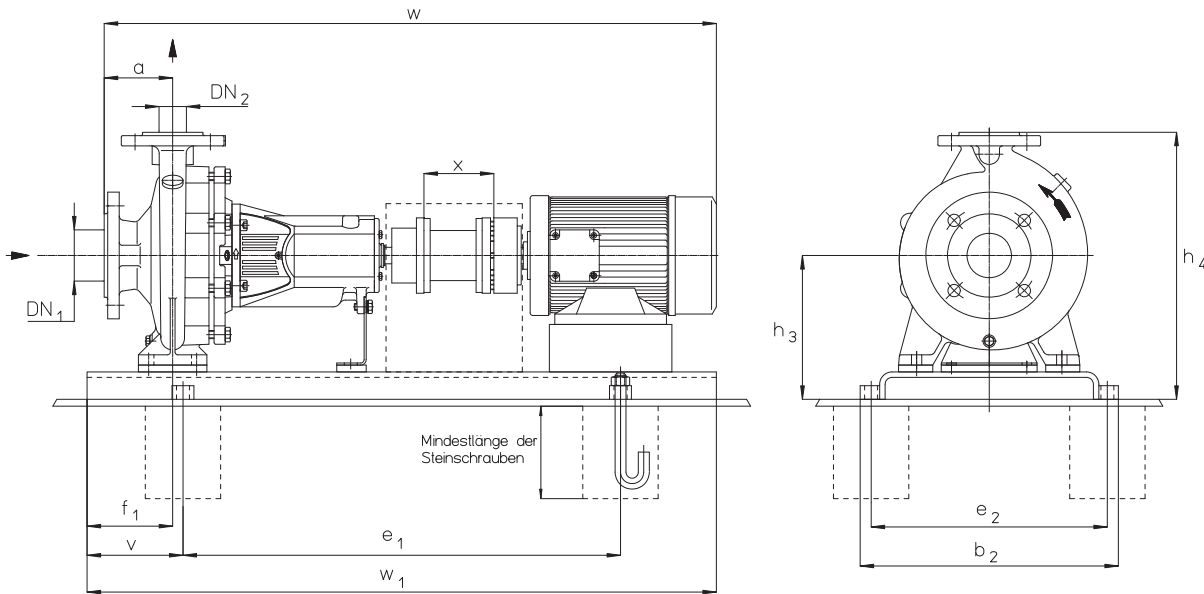

Dimensions in mm
Tolerances for welded parts acc. to DIN 8570 B.

Size	Motor		Base plate No.	Coupling	Weight kg		DN ₂	DN ₁	a	b ₂	e ₁	e ₂	v	f ₁	h ₃	h ₄	x	w*	w ₁	Rag bolt
	size	kW			Pump	unit														
32125	71	0,37	S272	H80	31	69	32	50	80	360	540	320	140	60	177	317	100	823	820	M16x200
32160	71	0,37			33	71									823					
	80	0,55			73	857														
32200	80	0,55	S015		34	74									857					
	80	0,75			76	857														
32250	90S	1,10	S383		46	79									857					
	80	0,75		105		877														
	90S	1,10		108		935														
	90L	1,50		112		935														
	100L	2,20		120		976														
40125	71	0,37	S272	H80	28	66	40	65	80	360	540	320	140	60	177	317	100	823	820	M20x200
40160	80	0,55			30	68									857					
	80	0,55			70	857														
40200	80	0,75	S342		36	75									857					
	90S	1,10				85									877					
	80	0,75				86									877					
	90S	1,10		89		935														
	90L	1,50		93		935														
40250	90S	1,10	S383	46	108	935														
	90L	1,50			112	935														
	100L	2,20			120	976														
	100L	3,00			123	976														
	100L	2,20			163	1111														
40315	100L	3,00	S605	73	165	1111														
	112M	4,00			170	1132														
	132S	5,50			186	1208														
	80	0,37			68	843														
50125	80	0,55	S272	H80	30	70	50	65	100	450	540	400	140	60	197	357	100	877	820	M16x200
	80	0,75			72	877														
	80	0,55			77	877														
50160	80	0,75	S342		36	79									877					
	90S	1,10				82									935					
50200	80	0,75	S303		40	91									935					
	90S	1,10		94		976														
	90L	1,50		97		976														
	100L	2,20		106		976														
50250	90L	1,50	S383	50	116	976														
	100L	2,20			125	976														
	100L	3,00			127	976														
	112M	4,00			132	997														
	112M	4,00			186	1132														
50315	132S	5,50	S605	88	201	1208														
	132M	7,50			226	1234														
	80	0,55			83	877														
65125	80	0,75	S342	H80	33	84	65	80	100	450	540	400	140	60	240	440	100	877	820	M20x400
	80	0,75			90	877														
	90L	1,50			97	935														
	100L	2,20			115	976														

* Motor protection type IP 55, dimensions depend on the motor manufacturer.
Dimensions listed are taken from the SIEMENS catalogue.

Size	Motor		Base plate No.	Coupling	Weight kg		DN ₂	DN ₁	a	b ₂	e ₁	e ₂	v	f ₁	h ₃	h ₄	x	w*	w ₁	Rag bolt
	size	kW			Pump	unit														
65200	90S	1,10	S383	H80	45	107	65	80	100	490	600	440	160	75	260	485	140	935	920	M20x400
	90L	1,50																935		
	100L	2,20																976		
	100L	3,00																976		
	112M	4,00																997		
65250	100L	2,20	S605	H80	70	159	65	80	100	730	740	670	190	90	300	550	140	1086	1120	M24x400
	100L	3,00																1086		
	112M	4,00																1007		
	132S	5,50																1183		
65315	132S	5,50	S435	H95	92	237	65	80	100	540	490	200	90	280	530	140	1183	1140	M20x400	
	132M	7,50	S486														1208			
	160M	11,00	S607														1234			
	160L	15,00	H110														1326			
80160	80	0,75	S383	H80	43	102	80	100	125	730	940	670	230	90	325	605	140	1388	1400	M24x400
	90S	1,10																102		
	90L	1,50																105		
	100L	2,20																108		
	100L	3,00																117		
80200	100L	1,50	S434	H80	60	126	80	100	125	540	660	490	170	75	280	530	140	1070	1000	M20x400
	100L	2,20	S605															119		
	100L	3,00	H95															126		
	112M	4,00	H80															149		
80250	132S	5,50	S486	H95	75	156	80	100	125	730	740	670	190	90	300	580	140	151	1250	M24x400
	100L	3,00																156		
	112M	4,00																172		
	132S	5,50																198		
80315	100L	3,00	S607	H110	95	203	80	100	125	610	840	550	205	90	350	665	140	219	1400	M24x400
	112M	4,00																219		
	132S	5,50																231		
	132M	7,50																240		
80400	132S	5,50	S607	H110	143	252	80	125	140	730	940	670	230	90	380	735	140	252	1400	M24x400
	132M	7,50																252		
	160M	11,00																273		
	160L	15,00																293		
100160	160L	15,00	S486	H95	143	324	80	125	140	730	940	670	230	90	380	735	140	324	1250	M24x400
	160L	15,00	S607															381		
	180M	18,50	H110															403		
	180L	22,00	H125															418		
	200L	30,00	H125															467		
100200	100L	2,20	S605	H80	78	168	100	125	140	730	940	670	190	90	300	580	140	1111	1120	M24x400
	100L	3,00																1111		
	112M	4,00																1175		
	132S	5,50																1204		
100250	100L	2,20	S435	H95	70	159	100	125	140	540	740	490	200	90	280	560	140	1111	1140	M20x400
	100L	3,00																1111		
	112M	4,00																1161		
	132S	5,50																1196		
	132M	7,50																1207		
100315	132S	5,50	S605	H80	85	214	100	125	140	730	740	670	190	90	300	580	140	1208	1140	M20x400
	132M	7,50																1207		
	160M	11,00																1214		
	132S	5,50																1230		
100400	132M	7,50	S486	H95	104	241	100	125	140	610	840	550	205	90	325	605	140	1249	1250	M24x400
	160M	11,00																1249		
	160L	15,00																1262		
	160L	15,00																1282		
125200	160L	15,00	S607	H110	177	302	125	150	140	730	940	670	230	110	380	735	140	1341	1400	M24x400
	180M	18,50																1341		
	180L	22,00																1403		
	200L	30,00																1465		
	225S	37,00																H140		
125250	225M	45,00	S608	H140	177	574	125	150	140	730	940	670	230	110	380	735	140	1580	1600	M24x400
	160L	15,00																1580		
	180M	18,50																1617		
	180L	22,00																1617		
125315	160L	15,00	S607	H110	151	390	125	150	140	730	940	670	230	110	380	735	140	1522	1400	M24x400
	180M	18,50																1522		
	180L	22,00																1552		
	200L	30,00																1580		
125400	225S	37,00	S608	H140	188	526	125	150	140	1060	680	170	200	455	855	140	1617	1600	M16x200	
	225S	37,00															1617			
	225M	45,00															1617			
	250M	55,00															1740			
150200	280S	75,00	180x73x14	H180	1054	1815	1800	1815	1800	1740	1815	1800	1815	1800	1815	1800	1815	1800	1815	1800
	132M	7,50	S606	H95	123	296	150	200	160	730	940	670	230	110	380	780	140	1269	1250	M24x400
	160M	11,00																1361		
	160L	15,00																1423		
	180M	18,50																1485		
180L	22,00	1485																		
150250	160L	15,00	S607	H110	128	354	150	200	160	730	940	670	230	110	380	780	140	1423	1400	M24x400
	180M	18,50																1485		
	180L	22,00																1485		
	200L	30,00																1543		

* Motor protection type IP 55, dimensions depend on the motor manufacturer. Dimensions listed are taken from the SIEMENS catalogue.

Size	Motor		Base plate No.	Coupling	Weight kg		DN ₂	DN ₁	a	b ₂	e ₁	e ₂	v	f ₁	h ₃	h ₄	x	w*	w ₁	Rag bolt								
	size	kW			Pump	unit																						
150315	180L	22,00	S607	H110	170	446	150	200	160	730	940	670	230	110	380	780	140	1542	1400	M24x400								
	200L	30,00		H125		495												1600										
	225S	37,00	S608	H140		546												1637										
	225M	45,00		H160		567												1637										
	250M	55,00		H140		798												1760										
150400	225M	45,00	S608	H140	205	603	150	200	160	730	1060	670	270	110	380	780	140	1637	1600	M24x400								
	250M	55,00		H160		835												1760										
	280S	75,00	180x73x 14	H180		1072												1460			680	170	200	455	905	1835	1800	M16x200
	280M	90,00				1125												1835										
	160L	15,00				S608												H110			230	492	200	200	160	730	1060	670
180M	18,50	512	1642																									
180L	22,00	527	1642																									
200L	30,00	H125	576	1700																								

* Motor protection type IP 55, dimensions depend on the motor manufacturer.
Dimensions listed are taken from the SIEMENS catalogue.

Foundation plan for units with spacer type coupling (bearing brackets 55 and 65)

n = 1450 rpm

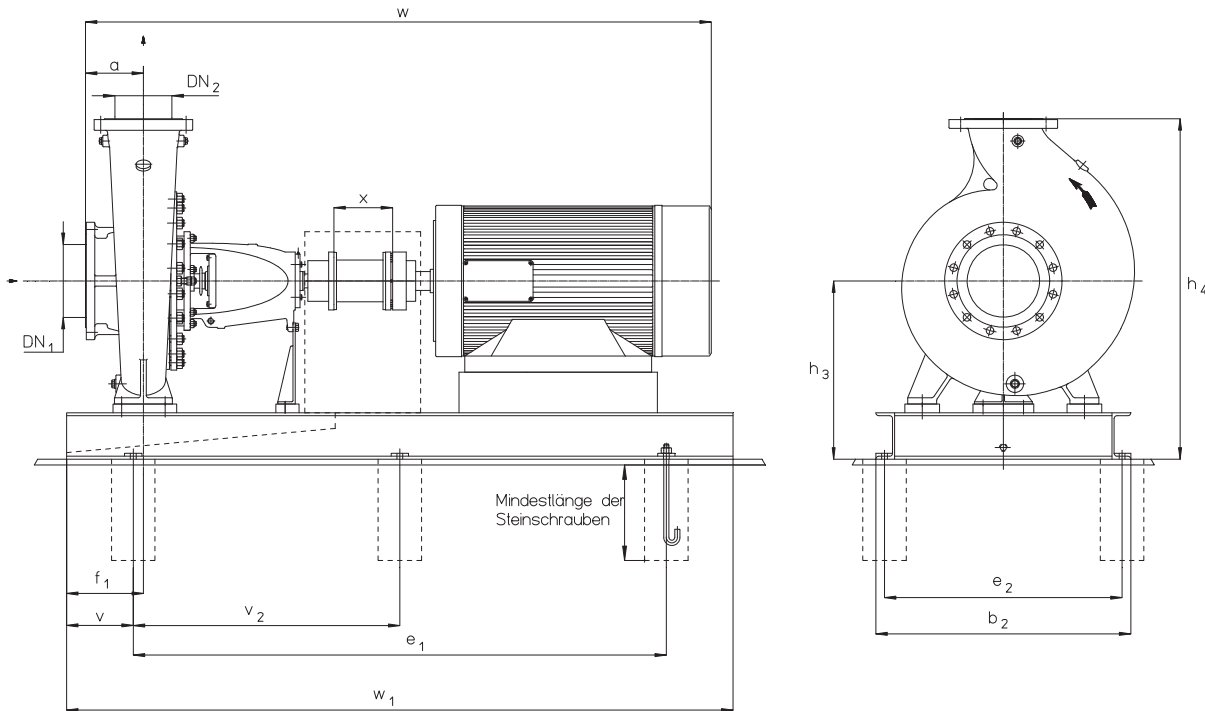

Dimensions in mm
Tolerances for welded parts acc. to DIN 8570 B

Size	Motor		Base plate No.	Coupling	Weight kg		DN ₂	DN ₁	a	b ₂	v	e ₁	e ₂	v ₂	f ₁	h ₃	h ₄	x	w*	w ₁	Rag bolt																																																					
	size	kW			Pump	unit																																																																				
150500	180L	22,0	185x81x12	H125	335	677	150	200	180	820	190	1470	760	735	235	550	1050	180	1742	1850	M16 x200																																																					
	200L	30,0	192x82x14	H140																		757	190	1540	770																																																	
	225S	37,0	196x82x14																							820	190	1580	790																																													
	225M	45,0	208x82x14	H160																		850	190	770	865					240	570	1070	2035	2150																																								
	250M	55,0																								961	210	1660	830																																													
	280S	75,0																																	215x82x14	H180	1193	210	1730	770	865																																	
	280M	90,0	230x83x16	H200						1406	230	1840	920	245	590	1090	2310	2440																																																								
	315S	110																	1486	230		1940	970																																																			
	315M	132																						1644	250	1940	970																																															
	315L	160																	244x83x16	H225		1784	250					1030	2430	2560																																												
	315L	200																	1625					870	250	2060	810				1030																																											
	315	250																		256x87x16		310	662					200	720	190		1490	670	745	255	505	955	180	1762	1870	M18 x200																																	
200315	22,0	187x72x12	H125	310	715	200	730	190	1560	780	800	260	525	975	180	1820	1940	M18 x200																																																								
200315	30,0	194x73x14	H140																780	190	1600			680	840																																																	
225S	37,0	198x73x14																								H160	810				190											1680	840																															
225M	45,0	210x73x14	H180																921	210	1750			690	875																			260	525	975	1980	2100																										
250M	55,0																									1102	740				210											1750	690						875	2055	2170																							
280S	75,0																																																			217x74x14	340	669	200	250	180	720	190	1470	670	735	235	505	1005	1742	1850	M16 x200						
200400	22,0	185x72x12	H125																340	745	250			730	190	1540	770				790											240	525	1025	180	1800	1920	M16 x200																										
200400	30,0	192x73x14	H140																																														810	190	1580	680																	790					
225S	37,0	196x73x14																																																																				H160	840	190	1660	830
225M	45,0	208x73x14	H180																																														951	210	1730	690																	865					
250M	55,0																																																																					1182	210	1730	690	865
280S	75,0																					215x74x14	H200					1409	230	1840		920	245	545	1045	2310	2440																																					
280M	90,0	230x82x16	H225	1489	230	760	970	245	545	1045	2310	2440																																																														
315S	110												1644	250	1940	970																																																										
315M	132																1784	250				1940	970																																																			
315L	160												244x82x16	H250	1630	250												1030	2430	2560																																												
315L	200												1630				870	250				2060	810									1030																																										
315	250													256x87x16	395	920												200	840	190			1600	800	260	595	1155	180	1857	1980	M16 x200																																	
200500	45,0	198x84x14	H140	395	1031	200	850	210	1680	840	260	595	1155	180			1980	2100	M16 x200																																																							
200500	30,0	210x84x14	H160																	1212	210	1750	790	875																																																		
225S	37,0	217x84x14																							H180	1262	210				1860	930																																										
225M	45,0	232x85x16	H200																	1474	230	1860	930	265																		615	1175	2330	2460																													
250M	55,0																								1554	230	1960				980																																											
280S	75,0																															217x84x14														H225	1849	250	1040	2450	2580																							
280M	90,0	246x85x16	H250																	1685	250	2080	810	1040	2450	2580																																																
315S	110																										1709				250	2080										810	1040	2450	2580																													
315M	132																																													1849	250	2080	810	1040	2450	2580																						
315L	160																										246x85x16				H250	1885										250	2080	810	1040								2450	2580																				
315L	200																										1885																			870	250	2080	810	1040																								
315	250														258x87x16	H250												1885	250	2080	810	1040	2450	2580																																								
315	315	281x98x18	H250	1885	250	2080	810	1040	2450	2580																																																																
355	355										281x98x18	H250	1985	290	2230	920	1115	270	635	1195	2675	2810																																																				

* Motor protection type IP 55, dimensions depend on the motor manufacturer.
Dimensions listed are taken from the SIEMENS catalogue.

Size	Motor		Base plate No.	Coupling	Weight kg		DN ₂	DN ₁	a	b ₂	v	e ₁	e ₂	v ₂	f ₁	h ₃	h ₄	x	w*	w ₁	Rag bolt												
	size	kW			Pump	unit																											
250300	225S	37	207x88x14	H140	416	898	250	300	305	880	210	1650	830	825	365	595	1145	180	1947	2070	M16x200												
	225M	45				928																											
	250M	55	219x88x14	H160		1044																											
	280S	75	226x88x14	H180		1225																											
250315	200L	30	199x80x14	H125	424	846	250	300	250	800	190	750	805	310	545	1105	180	1870	1990	M16x200													
	225S	37	203x80x14	H140		906																											
	225M	45				936																											
	250M	55	215x80x14	H160		1052																											
	280S	75	222x80x14	H180		1233																											
	280M	90				1283																											
	315S	110	237x82x16	H200		1496																											
	315M	132				1576																											
250400	225S	37	208x88x14	H140	464	962	250	300	250	880	210	830	830	310	570	1170	180	1957	2080	M16x200													
	225M	45				991																											
	250M	55	220x88x14	H160		1103																											
	280S	75	227x88x14	H180		1284																											
	280M	90				1334																											
	315S	110	242x89x16	H200		1552																											
	315M	132				1632																											
	315L	160	256x89x16	H250		1787																											
	315L	200				1927																											
	315	250	268x89x16			1758																											
	315	315				2158																											
	355	355	291x98x18			2063																											
250500	280S	75	227x93x14	H180	589	1431	250	300	250	930	230	880	905	310	620	1290	180	2155	2270	M16x200													
	280M	90				1480																											
	315S	110	242x94x16	H200		1703																											
	315M	132				1780																											
	315L	160	256x94x16	H250		1933																											
	315L	200				2068																											
	315	250	268x94x16			1903																											
	315	315				2197																											
	355	355	291x98x18			2202																											
	355	400				2242																											
300400	225M	45	213x94x14	H140	620	1143	300	350	300	940	210	890	855	360	595	1265	180	2007	2130	M16x200													
	250M	55	225x94x14	H160		1243																											
	280S	75	232x94x14	H180		1466																											
	280M	90				1515																											
	315S	110	247x95x16	H200		1733																											
	315M	132				1810																											
	315L	160	261x95x16	H250		1968																											
	315L	200				2103																											
	315	250	273x95x16			1949																											
	315	315				2248																											
	355	355	296x98x18			2253																											
	355	400				2290																											
300500	225M	45	213x102x14	H140	800	1263	300	350	300	1020	210	970	855	360	650	1320	180	2007	2130	M16x200													
	250M	55	225x102x14	H160		1471																											
	280S	75	232x102x14	H180		1654																											
	280M	90				1711																											
	315S	110	247x103x16	H200		1925																											
	315M	132				2007																											
	315L	160	261x103x16	H250		2170																											
	315L	200				2313																											
	315	250	273x103x16			2720																											
	315	315				2938																											
	355	355	296x104x18			3372																											
	355	400				3474																											
	355	500	**	**		**					**							**	**		**	**	**	**	**	**	**	**	**	**	**	**	
	400	560																															
	400	630																															
	400	710																															

* Motor protection type IP 55, dimensions depend on the motor manufacturer.

Dimensions listed are taken from the SIEMENS catalogue.

** On request.

Foundation plan for units with spacer type coupling (bearing brackets 25, 35 und 55)

n = 2900 rpm

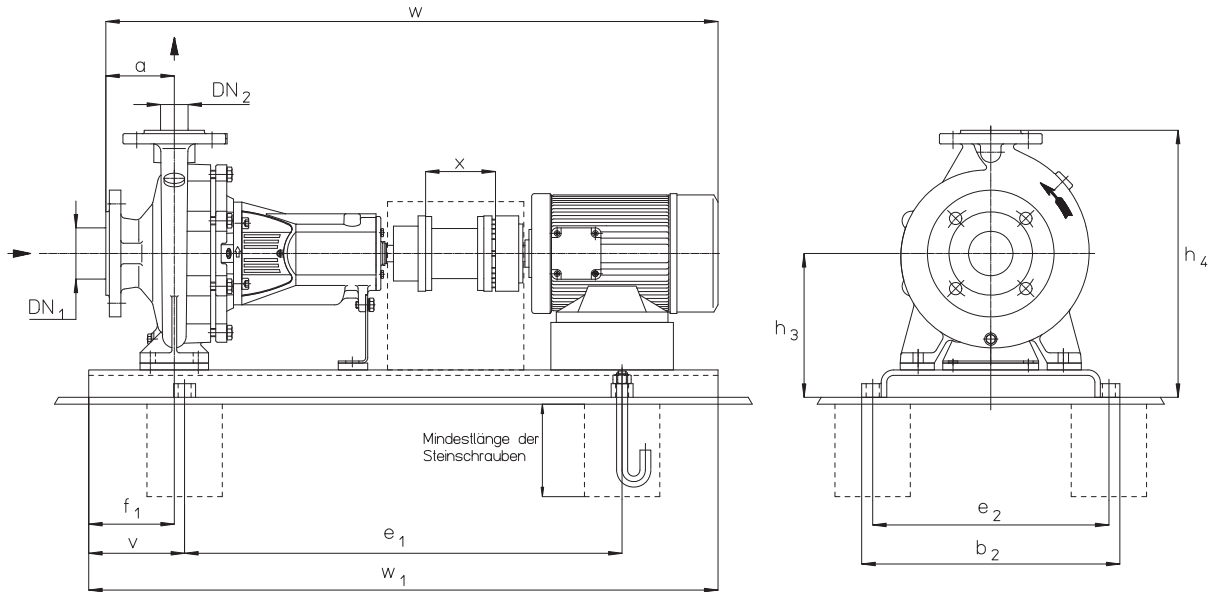

Dimensions in mm
Tolerances for welded parts acc. to DIN 8570 B

Size	Motor		Base plate No.	Coupling	Weight kg		DN ₂	DN ₁	a	b ₂	e ₁	e ₂	v	f ₁	h ₃	h ₄	x	w*	w ₁	Rag bolt
	size	kW			Pump	unit														
32125	71	0,55	S272	H80	31	70	32	50	80	360	540	320	140	60	177	317	100	823	820	M16x200
	80	0,75				71												857		
	80	1,10				73												857		
	90S	1,50				76												915		
	90L	2,20				79												915		
32160	90S	1,50	S385	H80	33	78	32	50	80	490	740	440	200	60	212	372	100	915	1140	M20x400
	90L	2,20				81												915		
	100L	3,00				89												956		
	112M	4,00				96												977		
32200	90L	2,20	S385	H80	34	82	32	50	80	490	740	440	200	60	240	420	100	915	1140	M20x400
	100L	3,00				90												956		
	112M	4,00				97												977		
	132S	5,50				121												1053		
	132S	7,50				131												1053		
32250	132S	7,50	S385	H95	46	152	32	50	100	490	740	440	200	75	260	485	100	1073	1140	M20x400
	160M	11,0				164												1191		
	160M	15,0				177												1191		
40125	80	1,10	S385	H80	28	70	40	65	80	730	740	670	190	60	192	332	100	857	1140	M20x400
	90S	1,50	S605			73												915		
	90L	2,20	S605			76												915		
	100L	3,00	S385			84												956		
40160	90S	1,50	S385	H80	30	75	40	65	80	730	740	670	190	60	212	372	100	915	1140	M20x400
	90L	2,20				78												915		
	100L	3,00				86												956		
	112M	4,00				93												977		
40200	132S	5,50	S605	H95	36	116	40	65	100	730	740	670	190	60	232	392	100	1053	1120	M24x400
	100L	3,00				101												976		
	112M	4,00				106												997		
	132S	5,50				123												1073		
	132S	7,50				133												1073		
40250	160M	11,00	S605	H95	46	164	40	65	100	730	740	670	190	75	260	440	100	1191	1120	M24x400
	132S	7,50				152												1073		
	160M	11,00				193												1191		
	160M	15,00				207												1191		
	160L	18,50				S385												225		
50125	90S	1,50	S015	H80	30	75	50	65	100	361	600	325	160	60	182	342	100	935	920	M12x100
	90L	2,20	S434			78												935		
	132S	5,50	S434			116												1073		
50160	90L	2,20	S303	H80	36	93	50	65	100	390	600	350	160	60	212	372	100	1073	1000	M20x400
	100L	3,00	S385			101												935		
	112M	4,00	S303			108												997		
	132S	5,50	S434	H95	36	123	50	65	100	390	600	350	160	60	225	405	100	976	1140	M20x400
	132S	7,50	S434			133												1073		
	160M	11,00	S605			164												1191		
	160L	15,00	S605			207												1191		

* Motor protection type IP 55, dimensions depend on the motor manufacturer.
Dimensions listed are taken from the SIEMENS catalogue.

Size	Motor		Base plate No.	Coupling	Weight kg		DN ₂	DN ₁	a	b ₂	e ₁	e ₂	v	f ₁	h ₃	h ₄	x	w*	w ₁	Rag bolt													
	size	kW			Pump	unit																											
50200	100L	3,00	S303	H80	40	105	50	65	100	390	600	350	160	60	225	425	100	976	920	M16													
	112M	4,00	S434			H95												112	997	1000	M20												
	132S	5,50		127														1073															
	132S	7,50		137														1073															
	160M	11,00		168														1191															
	160M	15,00	S605	182		1191												1120	M24														
50250	160M	15,00	S385	H95	50	211	65	80	100	730	740	670	190	75	260	485	140	1191	1140	M20													
	160L	18,50				229												1253	1140	M20													
	180M	22,00	S486	H110		250												1315	1250	M24													
	200L	30,00	H125	281		1373												1250	M24														
65125	100L	3,00	S383	H80	33	108	65	80	100	490	600	440	160	60	240	660	100	976	920	M20													
	112M	4,00	S385			115												997	1140														
	132S	5,50	S434	H95		130												1073	1000		M20												
	132S	7,50				141												1073															
	132S	5,50				136												1073															
65160	132S	5,50	S605	H95	39	147	65	80	100	730	740	670	190	60	260	460	140	1191	1120	M24													
	160M	11,00				167												1191	1120	M24													
	160M	15,00				180												1191	1120	M24													
65200	160M	11,00	S605	H95	45	192	65	80	100	730	740	670	190	75	280	505	140	1191	1140	M20													
	160M	15,00				206												1191	1140	M20													
	160L	18,50	S385			224												1253	1140	M20													
	180M	22,00	S486			H110												240	1315	1250	M24												
65250	200L	30,00	S607	H110	70	300	65	80	100	610	840	550	205	90	300	550	140	1373	1250	M24													
	200L	37,00				335												1483	1400		M24												
	225M	45,00	S608	H125		414												1513	1600		M24												
	160L	18,50	S607	H95		43												264	80		100	125	730	940	670	230	75	280	505	140	1098	1120	M24
	160M	11,00																190													1216	1140	M20
	160M	15,00																S385													204	1216	1140
160L	18,50	222			1278		1250	M24																									
180M	22,00	S486	H110	237	1340		1400	M24																									
160M	15,00	S436	H110	60	227		80	100	125	610	840	550	205	75	280	530	140	1326		1250											M20		
160L	18,50				253	1388												1270	M20														
180M	22,00	269	1450		1270	M20																											
200L	30,00	S607	H125		324	1508												1400	M24														
200L	37,00				348	1508																											
80200	180M	22,00	S607		H110	75												295	65	80	100	730	940	670	230	90	300	580	140	1450	1400	M24	
	200L	30,00		H125			350	1508	1400	M24																							
	200L	37,00	374	1508	1400		M24																										
	225M	45,00	S608	H125	450		1538	1600	M24																								
	250M	55,00			H140		655	1668	1600	M24																							
100160	160L	18,50	S607	H95	78	272	65	80	100	730	940	670	230	90	300	580	140	1388	1400	M24													
	180M	22,00				H110												288	1450		1400	M24											
	200L	30,00				H125												343	1508		1400	M24											
	200L	37,00				367												1508	1400		M24												
100200	160L	18,50	S607	H95	70	264	65	80	100	730	940	670	230	90	300	580	140	1388	1400	M24													
	180M	22,00				H110												280	1450		1400	M24											
	200L	30,00				335												1508	1400		M24												
	200L	37,00				359												1508	1400		M24												
	225M	45,00				S608												H125	445		1538	1600	M24										
100250	200L	30,00	S607	H110	85	350	65	80	100	730	940	670	230	90	325	605	140	1523	1400	M24													
	200L	37,00				374												1523	1400		M24												
	225M	45,00	S608	H140		461												1553	1600		M24												
	250M	55,00				666												1683	1600		M24												
	280S	75,00	S609A	H160		850												1783	1800		M24												
	280M	90,00				892												1783	1800		M24												
125200	250M	55,00	S608	H140	100	682	65	80	100	730	1060	670	270	90	350	665	140	1683	1600	M24													
	280S	75,00	S609A	H160		865				1783								1800	M24														
	280M	90,00	907	1783		1800				M24																							

* Motor protection type IP 55, dimensions depend on the motor manufacturer.
Dimensions listed are taken from the SIEMENS catalogue.

Data regarding size – order information

Type	Size	Hydraulic + Bearing	Shaft Seal	Material	Casing Gasket
		<ul style="list-style-type: none"> A• First hydraulic B• Second hydraulic D• Double volute •B Two ball bearings greased for life (2Z) •C Two ball bearings oil lubricated •S One double row angular contact bearing plus one ball bearing, grease lubricated •T One double row ball bearing plus ball bearing, oil lubricated •2 Oil lubrication configurations with CLO 	041: Self-sealed, uncooled packing rings 052: Uncooled packing rings, external seal liquid AF3: Balanced mechanical seal, seal face materials SiC/Carbon, elastomer EPDM BJ3: Unbalanced bellows mechanical seal, seal face materials SiC/Carbon, elastomer EPDM C23: Unbalanced bellows mechanical seal, seal face materials SiC/Carbon, elastomer EPDM AFS: Balanced mechanical seal, seal face materials SiC/ SiC, elastomer FPM (Viton) BJS: Unbalanced bellows mechanical seal, seal face materials SiC/ SiC, elastomer FPM (Viton) C2S: Unbalanced bellows mechanical seal, seal face materials SiC/ SiC, elastomer FPM (Viton) AFK: Unbalanced bellows mechanical seal, seal face materials SiC/ Carbon, elastomer FPM (Viton) double PTFE (Teflon) wrapped BJJ: Unbalanced bellows mechanical seal, seal face materials SiC/ Carbon, elastomer FPM (Viton) C2J: Unbalanced bellows mechanical seal, seal face materials SiC/ Carbon, elastomer FPM (Viton) AX3,AXS,AXK: AF3,AFS,AFK plus quench AY3,AYS,AYK: AF3,AFS,AFK plus heating A93,A9S,A9K: AF3,AFS,AFK plus external flushing	0B: Cast iron GG25 0C: Cast iron GG25, Bronze G-CuSn10 impeller 0E: Cast iron GG25, stainless steel 1.4408 impeller 4B: Stainless steel 1.4408	2: Confined flat gasket of EWP 210 material 4: Confined flat gasket of PTFE
ZLND	32125	AB, AC or A2	alternatively	alternatively	alternatively
	32160	AB, AC, A2, BB,BC or B2			
	32200	AB, AC, A2, BB,BC or B2			
	32250				
	40125				
	40160				
	40200				
	40250				
	40315				
	50125				
	50160				
	50200				
	50250				
	50315				
	65125				
	65160				
	65200				
	65250				
	65315				
	80160				
	80200				
	80250	AB, AC or A2			
	80315				
	80400				
	100160				
	100200				
	100250				
	100315				
	100400				
	125200				
	125250				
	125315				
125400					
150200					
150250					
150315					
150400					
150500	AS, AT or A2	alternatively			
200250	AB, AC or A2				
200315	AS, AT or A2				
200400					
200500	DS, DT or D2				
250300					
250315	AS, AT or A2				
250400					
250500	DS, DT or D2				
300400					
300500					
		041, 052, 052, BJ3, C23, AF3, AX3, AY3, A93, BJS, C2S, AFS, AXS, AYS, A9S, BJJ, C2J, AFK, AXK, AYK, A9K	0B, 0C, 0E, 4B	2 or 4	
		041, 051, 052, BJ3, C23, AF3, BJS, C2S, AFS, BJJ, C2J, AFK			

Any changes in the interest of the technical development are reserved.

Sterling SIHI GmbH

Lindenstraße 170, D-25524 Itzehoe, Germany, Tel. +49 (0) 48 21 / 7 71 - 01, Fax +49 (0) 48 21 / 7 71-274